

yasaka

Industrial Robots Positioners Welding Machines

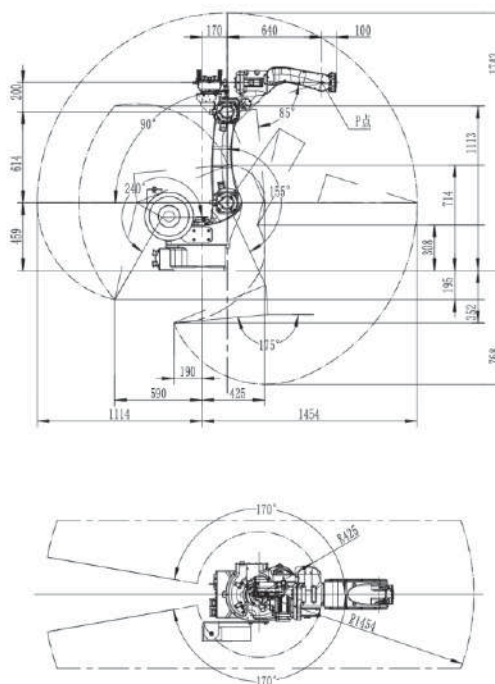



Robot specifications

Basic parameters	
Model No.	YS-RH14-10-W
Controlled axis	6-DOF
Max payload	10 kg
Max stroke	1440mm
IP Level	J1, J2-IP56; J3, J4, J5, J6-- IP67
Installation mode	Floor type, ceiling type
Robot mass	170 kg
Repeatability	±0.08 mm
Welding machines	<ul style="list-style-type: none"> Standard: Megmeet Ehave CM350AR/Aotai NBC-350R. Optional: Megmeet Artsen, Artsen Plus or Aotai 350RL, 350RP etc. Subject to customer requirements.
Welding current	350A/500A
Welding torch	Standard air-cooling torch with built-in anti-collision protection
Travel range	
J1 axis S	±167°
J2 axis L	+0°~175°
J3 axis U	-80°~150°
J4 axis R	±190°
J5 axis B	-105°~+130°
J6 axis T	±210°
Travel speed	
J1 axis S	169°/s
J2 axis L	169°/s
J3 axis U	169°/s
J4 axis R	280°/s
J5 axis B	240°/s
J6 axis T	520°/s

Electrical cabinet specifications

Dimensions	785*550*435mm
Cabinet Mass	60KG
Cooling method	Natural cooling
IP Level	IP54
Input power	3PH 380VAC 50/60Hz
Transformer	3.0KVA (380V to 220V isolated transformer)
I/O signal	Digital input/output ; 2 analog output 0~10V
LAN	Modbus TCP/IP

Installation environment

Ambient temperature	0~45°C
Humidity	20~80%RH, no condensing
Vibrations	Below 0.5G
Altitude	Below 1000m
Other requirements	<ul style="list-style-type: none"> With no corrosive or combustible gas With no water, oil or drug splashing With no electromagnetic field nearby With no radiations nearby

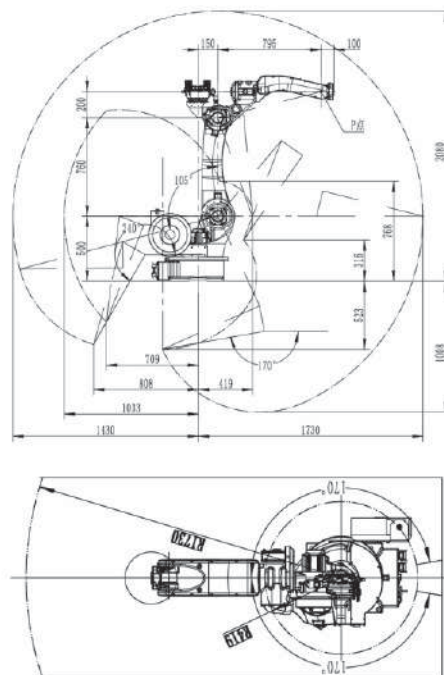

Robot specifications

Basic parameters	
Model No.	YS-RH18-20-W
Controlled axis	6-DOF
Max payload	20 kg
Max stroke	1720mm
IP Level	J1, J2-IP56; J3, J4, J5, J6--IP67
Installation mode	Floor type, ceiling type
Robot mass	285 kg
Repeatability	±0.08 mm
Welding machines	<ul style="list-style-type: none"> •Standard: Megmeet Ehave CM350AR(MIG/MAG/CO2) •Optional: Aotai NBC-350R •Optional: Aotai MIG-350RP (pulse MIG)
Welding current	350A/500A
Welding torch	Standard air-cooling torch with built-in anti-collision protection
Travel range	
J1 axis S	±167°
J2 axis L	0°~175°
J3 axis U	-80°~+150°
J4 axis R	±190°
J5 axis B	-105°~+130°
J6 axis T	±210°
Travel speed	
J1 axis S	159 ' /s
J2 axis L	159 ' /s
J3 axis U	169 ' /s
J4 axis R	280 ' /s
J5 axis B	240 ' /s
J6 axis T	483 ' /s

Electrical cabinet specifications

Dimensions	800*600*500mm
Cabinet Mass	75KG
Cooling method	Natural cooling
IP Level	IP54
Input power	3PH 380VAC 50/60Hz
Transformer	5.0KVA(380V to 220V isolated transformer)
I/O signal	16-in / 16-out 24VDC; 2 analog output 0~10V
LAN	EtherCAT, TCP/IP

Installation environment

Ambient temperature	0~45°C
Humidity	20~80%RH, no condensing
Vibrations	Below 0.5G
Altitude	Below 1000m
Other requirements	<ul style="list-style-type: none"> •With no corrosive or combustible gas •With no water, oil or drug splashing •With no electromagnetic field nearby •With no radiations nearby

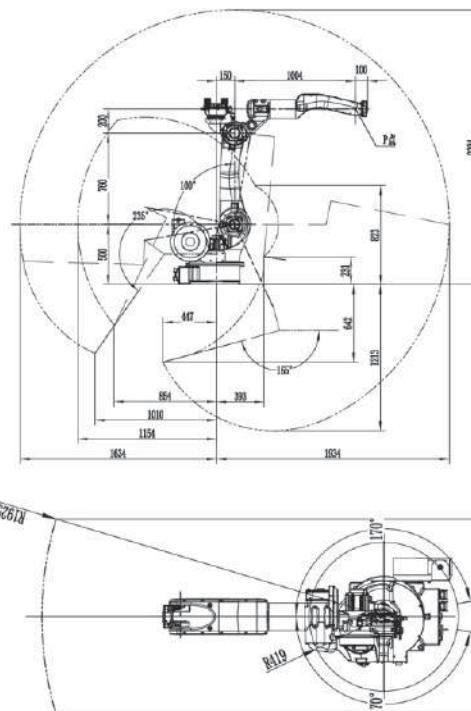

Robot specifications

Basic parameters	
Model No.	YS-RH20-10-W
Controlled axis	6-DOF
Max payload	10 kg
Max stroke	1920mm
IP Level	J1, J2-IP56; J3, J4, J5, J6--IP67
Installation mode	Floor type, ceiling type
Robot mass	288 kg
Repeatability	±0.08 mm
Welding machines	<ul style="list-style-type: none"> •Standard: Megmeet Ehave CM350AR(MIG/MAG/CO2) •Optional: Aotai NBC-350R •Optional: Aotai MIG-350RP (pulse MIG)
Welding current	350A/500A
Welding torch	Standard air-cooling torch with built-in anti-collision protection
Travel range	
J1 axis S	±167°
J2 axis L	0°~175°
J3 axis U	-80°~+150°
J4 axis R	±190°
J5 axis B	-105°~+130°
J6 axis T	±210°
Travel speed	
J1 axis S	159 °/s
J2 axis L	159 °/s
J3 axis U	169 °/s
J4 axis R	280 °/s
J5 axis B	240 °/s
J6 axis T	483 °/s

Electrical cabinet specifications

Dimensions	800*600*500mm
Cabinet Mass	75KG
Cooling method	Natural cooling
IP Level	IP54
Input power	3PH 380VAC 50/60Hz
Transformer	5.0KVA (380V to 220V isolated transformer)
I/O signal	16-in / 16-out 24VDC; 2 analog output 0~10V
LAN	EtherCAT, TCP/IP

Installation environment

Ambient temperature	0~45°C
Humidity	20~80%RH, no condensing
Vibrations	Below 0.5G
Altitude	Below 1000m
Other requirements	<ul style="list-style-type: none"> •With no corrosive or combustible gas •With no water, oil or drug splashing •With no electromagnetic field nearby •With no radiations nearby



WELDING ROBOT

YS10-1440-W

Faster, more accurate and more reliable.
Suitable for all types of CO₂/MAG/MIG/TIG welding and plasma cutting.

Robot specifications

Basic data	
Model No.	YS10-1440-W
Number of axes	6
Maximum payload	10 kg
Maximum stroke	1440mm
IP class	J1, J2 - IP56; J3, J4, J5, J6- IP67
Mounting position	Floor type, wall type, ceiling type
Approx. weight	176 kg (without cabinet or welding machine)
Repeatability	±0.05 mm
Internal air duct	Φ10
Welding machines	<ul style="list-style-type: none"> • Aotai NBC-350RL (CO₂/MAG/MIG, standard) • Aotai NBC-350/500RP (CO₂/MAG/MIG, optional) • Aotai MIG-350/500/630RP (CO₂/MAG/MIG, optional) • Aotai WSM-400R/WSME-315R (TIG, optional)
Motion range	
J1 axis S	±160°
J2 axis L	+80°~-145°
J3 axis U	+145°~-75°
J4 axis R	±190°
J5 axis B	+50°~-210°
J6 axis T	±220°
Speed with rated payload	
J1 axis S	209 °/s
J2 axis L	199 °/s
J3 axis U	209 °/s
J4 axis R	314 °/s
J5 axis B	272 °/s
J6 axis T	1353 °/s

Electrical cabinet specifications	
Dimensions	650*495*580mm
Approx. weight	60KG
Cooling method	Natural cooling
Input power	220VAC 50/60Hz
Grounding	Industrial grounding (grounding resistance below 100Ω)
I/O terminals	<ul style="list-style-type: none"> • 16 digital inputs • 16 digital outputs • 2 analog outputs (optional)
Position control mode	EtherCAT, TCP/IP
Serial port I/F	RS485*1, RS422*1, RS232*1, CAN*1, USB*1
RAM capacity	JOB 200,000 steps, 10,000 robot commands (200MB)
Driving unit	6-axis AC servo system. External axis can be added as an option.

Operating conditions	
Use temperature	0~45°C
Storage temperature	-20~60°C
Humidity	10~90% RH, no condensing
Vibrations	Below 0.5G
Altitude	Below 1000m. (Degrade if over 1000m, max 2000m)
Other requirements	<ul style="list-style-type: none"> • With no corrosive or combustible gas • With no water, oil or drug splashing • With no electromagnetic field nearby • With no radiations nearby

► Working envelope (unit: mm)

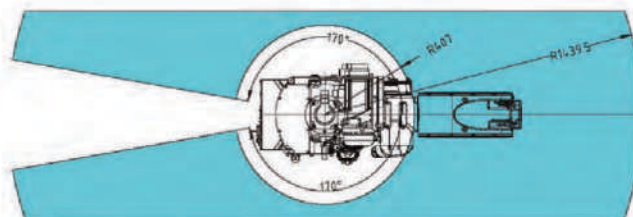
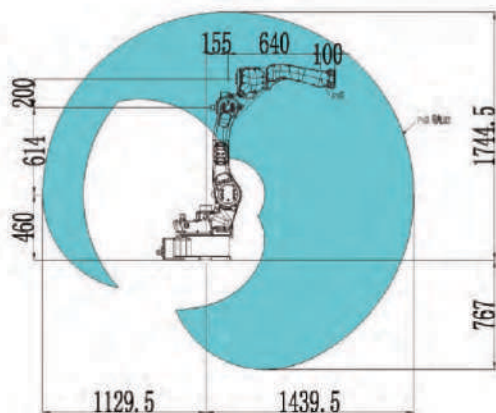

► Flange and base dimensions (unit: mm)

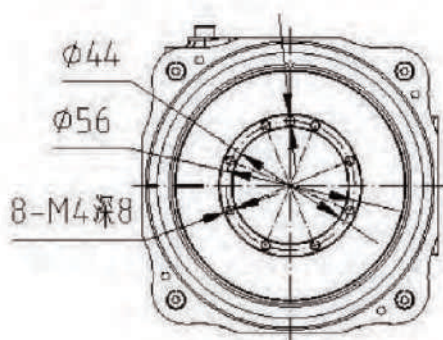

Flange

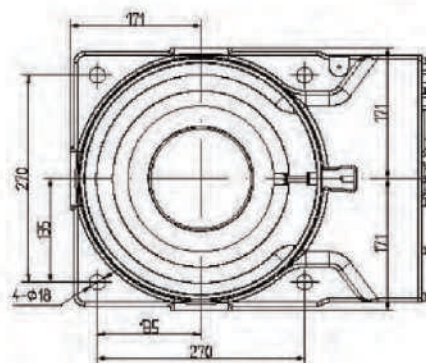

Base

► Payload diagram

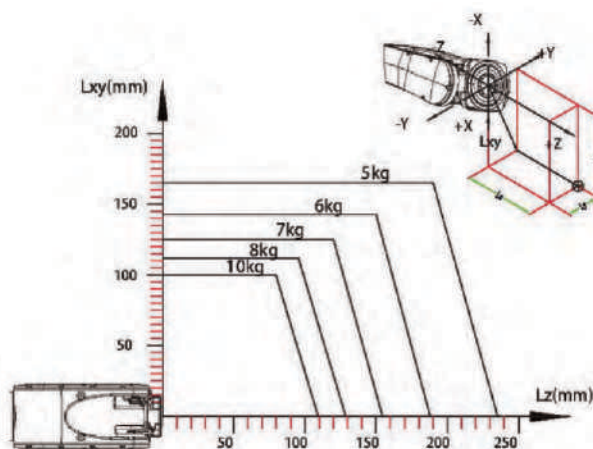

All data, drawings and specifications provided in this catalog are purely for information purposes and do not constitute a guarantee of these characteristics. The extent of goods delivered and services performed is determined by the subject matter of the specific contract. No liability accepted for errors or omissions.

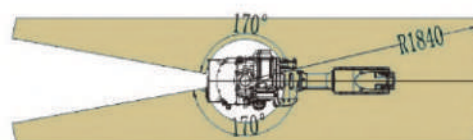
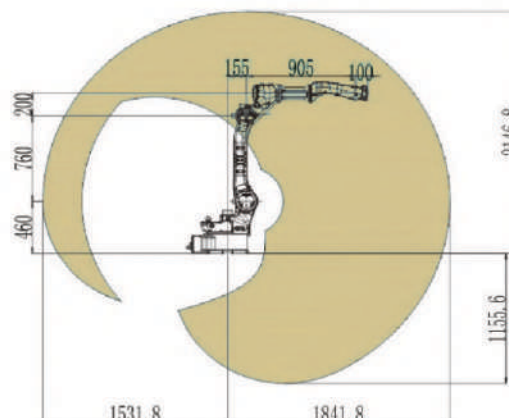

Robot specifications

Basic parameters	
Model No.	YS08-1840-W
Controlled axis	6-DOF
Max payload	8 kg
Max stroke	1840 mm
IP Level	J1, J2-IP56; J3, J4, J5, J6-- IP67
Installation mode	Floor type, ceiling type
Robot mass	180 kg
Repeatability	±0.05 mm
Welding machines	<ul style="list-style-type: none"> Standard: Megmeet Ehave CM350AR/Aotai NBC-350R. Optional: Megmeet Artsen, Artsen Plus or Aotai 350RL, 350RP etc. Subject to customer requirements.
Welding current	350A/500A
Welding torch	Standard air-cooling torch with built-in anti-collision protection
Travel range	
J1 axis S	±160°
J2 axis L	+80°~145°
J3 axis U	+145°~75°
J4 axis R	±190°
J5 axis B	+50°~210°
J6 axis T	±360°
Travel speed	
J1 axis S	150 °/s
J2 axis L	149 °/s
J3 axis U	150 °/s
J4 axis R	392 °/s
J5 axis B	272 °/s
J6 axis T	520 °/s

Electrical cabinet specifications

Dimensions	600*500*590mm
Cabinet Mass	72KG
Cooling method	Natural cooling
IP Level	IP54
Input power	3PH 380VAC 50/60Hz
Transformer	4.5KVA (380V to 220V isolated transformer)
I/O signal	16-in / 16-out 24VDC; 2 analog output 0~10V
LAN	EtherCAT, TCP/IP
Serial port I/F	RS485*1, RS422*1, RS232*1, CAN*1, USB*1
RAM capacity	JOB 200,000 steps (200MB)

Installation environment

Ambient temperature	0~45°C
Humidity	20~80%RH, no condensing
Vibrations	Below 0.5G
Altitude	Below 1000m
Other requirements	<ul style="list-style-type: none"> With no corrosive or combustible gas With no water, oil or drug splashing With no electromagnetic field nearby With no radiations nearby

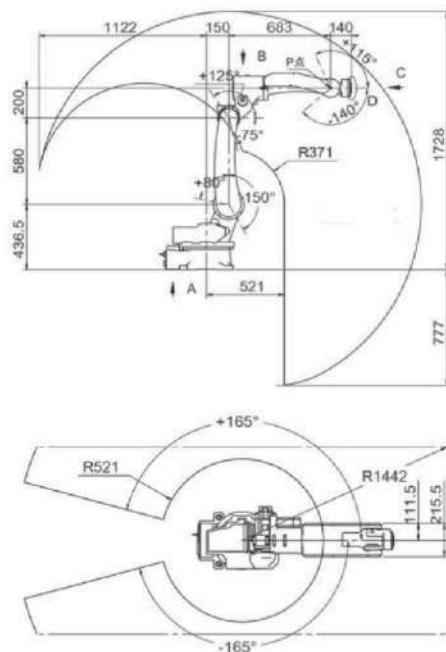

Robot specifications

Basic parameters	
Model No.	YS06H-1450-W
Controlled axis	6-DOF
Max payload	6 kg
Max stroke	1450mm
IP Level	J1, J2-IP56; J3, J4, J5, J6--IP67
Installation mode	Floor type, ceiling type
Robot mass	170 kg
Repeatability	±0.08 mm
Welding machines	<ul style="list-style-type: none"> •Standard: Megmeet Ehave CM350AR(MIG/MAG/CO2) •Optional: Aotai NBC-350R •Optional: Aotai MIG-350RP (pulse MIG)
Welding current	350A/500A
Welding torch	Standard air-cooling torch with built-in anti-collision protection
Travel range	
J1 axis S	±165°
J2 axis L	+80°~-150°
J3 axis U	+125°~-75°
J4 axis R	±170°
J5 axis B	+115°~-140°
J6 axis T	±220°
Travel speed	
J1 axis S	145 °/s
J2 axis L	133 °/s
J3 axis U	145 °/s
J4 axis R	217 °/s
J5 axis B	172 °/s
J6 axis T	500 °/s

Electrical cabinet specifications

Dimensions	800*600*500mm
Cabinet Mass	70KG
Cooling method	Natural cooling
IP Level	IP54
Input power	3PH 380VAC 50/60Hz
Transformer	3.7KVA (380V to 220V isolated transformer)
I/O signal	16-in / 16-out 24VDC; 2 analog output 0~10V
LAN	EtherCAT, TCP/IP

Installation environment

Ambient temperature	0~45°C
Humidity	20~80%RH, no condensing
Vibrations	Below 0.5G
Altitude	Below 1000m
Other requirements	<ul style="list-style-type: none"> •With no corrosive or combustible gas •With no water, oil or drug splashing •With no electromagnetic field nearby •With no radiations nearby

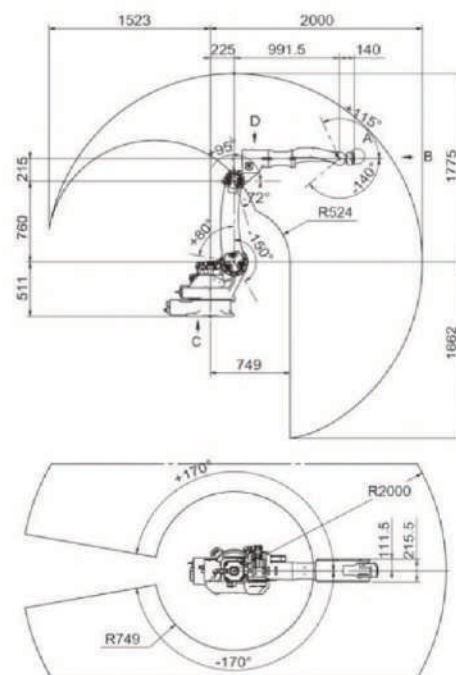

Robot specifications

Basic parameters	
Model No.	YS10H-2000-W
Controlled axis	6-DOF
Max payload	6 kg
Max stroke	2000mm
IP Level	J1, J2-IP56; J3, J4, J5, J6--IP67
Installation mode	Floor type, ceiling type
Robot mass	300 kg
Repeatability	±0.08 mm
Welding machines	<ul style="list-style-type: none"> •Standard: Megmeet Ehave CM350AR(MIG/MAG/CO2) •Optional: Aotai NBC-350R •Optional: Aotai MIG-350RP (pulse MIG)
Welding current	350A/500A
Welding torch	Standard air-cooling torch with built-in anti-collision protection
Travel range	
J1 axis S	±170°
J2 axis L	+80°~150°
J3 axis U	+95°~72°
J4 axis R	±170°
J5 axis B	+115°~140°
J6 axis T	±220°
Travel speed	
J1 axis S	158 °/s
J2 axis L	145 °/s
J3 axis U	140 °/s
J4 axis R	217 °/s
J5 axis B	172 °/s
J6 axis T	500 °/s

Electrical cabinet specifications

Dimensions	800*600*500mm
Cabinet Mass	75KG
Cooling method	Natural cooling
IP Level	IP54
Input power	3PH 380VAC 50/60Hz
Transformer	6.5KVA (380V to 220V isolated transformer)
I/O signal	16-in / 16-out 24VDC; 2 analog output 0~10V
LAN	EtherCAT, TCP/IP

Installation environment

Ambient temperature	0~45°C
Humidity	20~80%RH, no condensing
Vibrations	Below 0.5G
Altitude	Below 1000m
Other requirements	<ul style="list-style-type: none"> •With no corrosive or combustible gas •With no water, oil or drug splashing •With no electromagnetic field nearby •With no radiations nearby



WELDING ROBOT

YS06-2000-W

Faster, more accurate and more reliable.
Suitable for all types of CO₂/MAG/MIG/TIG welding and plasma cutting.

Robot specifications

Basic data	
Model No.	YS06-2000-W
Number of axes	6
Maximum payload	12 kg
Maximum stroke	2010mm
IP class	J1, J2 - IP56; J3, J4, J5, J6 - IP67
Mounting position	Floor type, wall type, ceiling type
Approx. weight	186 kg (without cabinet or welding machine)
Repeatability	±0.05 mm
Internal air duct	Φ10
Welding machines	<ul style="list-style-type: none"> • Aotai NBC-350RL (CO₂/MAG/MIG, standard) • Aotai NBC-350/500RP (CO₂/MAG/MIG, optional) • Aotai MIG-350/500/630RP (CO₂/MAG/MIG, optional) • Aotai WSM-400R/WSME-315R (TIG, optional)
Motion range	
J1 axis S	±160°
J2 axis L	+80°~-145°
J3 axis U	+145°~-75°
J4 axis R	±190°
J5 axis B	+50°~-210°
J6 axis T	±220°
Speed with rated payload	
J1 axis S	179 °/s
J2 axis L	179 °/s
J3 axis U	162 °/s
J4 axis R	315 °/s
J5 axis B	276 °/s
J6 axis T	1356 °/s

Electrical cabinet specifications	
Dimensions	650*495*580mm
Approx. weight	60KG
Cooling method	Natural cooling
Input power	220VAC 50/60Hz
Grounding	Industrial grounding (grounding resistance below 100Ω)
I/O terminals	<ul style="list-style-type: none"> • 16 digital inputs • 16 digital outputs • 2 analog outputs (optional)
Position control mode	EtherCAT, TCP/IP
Serial port I/F	RS485*1, RS422*1, RS232*1, CAN*1, USB*1
RAM capacity	JOB 200,000 steps, 10,000 robot commands (200MB)
Driving unit	6-axis AC servo system. External axis can be added as an option.

Operating conditions	
Use temperature	0~45°C
Storage temperature	-20~60°C
Humidity	10~90% RH, no condensing
Vibrations	Below 0.5G
Altitude	Below 1000m. (Degrade if over 1000m, max 2000m)
Other requirements	<ul style="list-style-type: none"> • With no corrosive or combustible gas • With no water, oil or drug splashing • With no electromagnetic field nearby • With no radiations nearby

► Working envelope (unit: mm)

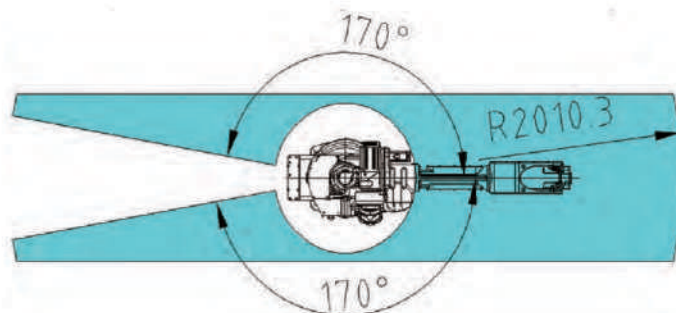
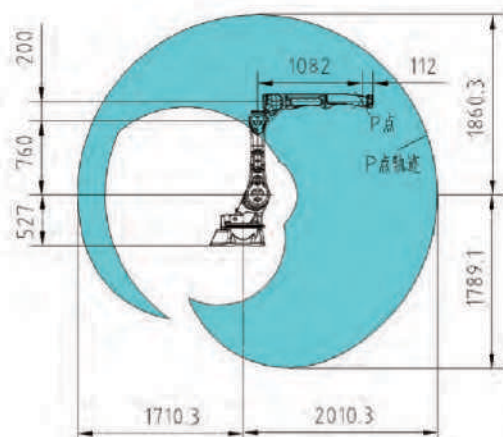

► Flange and base dimensions (unit: mm)

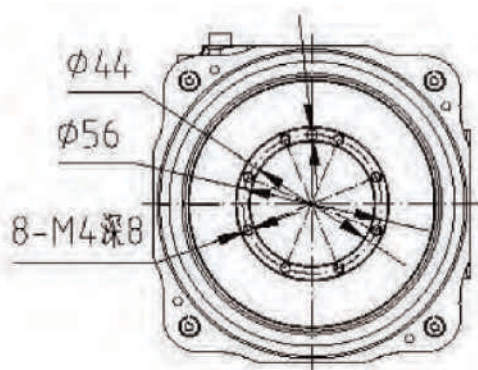

Flange

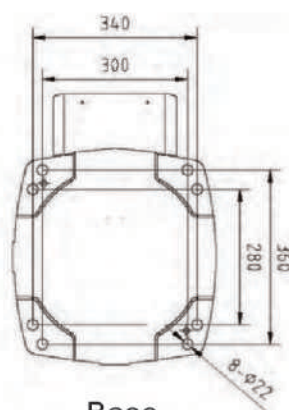

Base

► Payload diagram

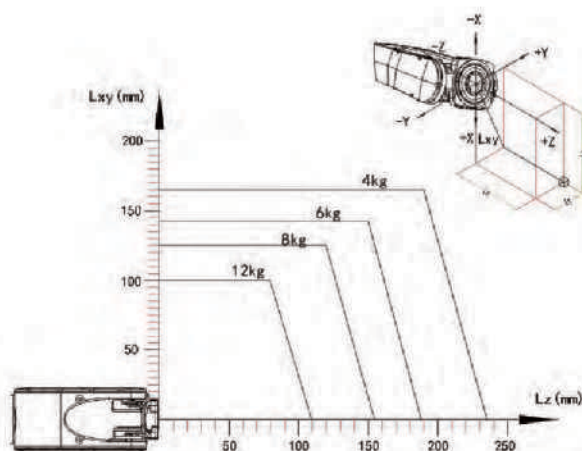

All data, drawings and specifications provided in this catalog are purely for information purposes and do not constitute a guarantee of these characteristics. The extent of goods delivered and services performed is determined by the subject matter of the specific contract. No liability accepted for errors or omissions.

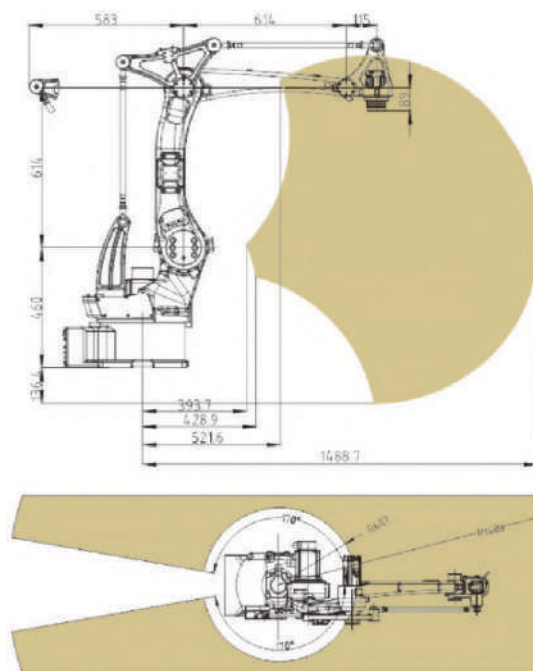

Robot specifications

Basic parameters	
Model No.	YS10C-1488
Controlled axis	4-DOF
Max payload	10 kg
Max stroke	1488mm
IP Level	J1, J2-IP56; J3, J4- IP67
Installation mode	Floor type, ceiling type
Robot mass	165 kg
Repeatability	±0.08 mm
Applications	<ul style="list-style-type: none"> ●Pick-n-place ●Palletizing
Travel range	
J1 axis S	±170°
J2 axis L	+80°~32°
J3 axis U	+20°~90°
J4 axis R	±360°
Travel speed	
J1 axis S	150°/s
J2 axis L	149°/s
J3 axis U	300°/s
J4 axis R	222°/s

Electrical cabinet specifications

Dimensions	600*500*590mm
Cabinet Mass	72KG
Cooling method	Natural cooling
IP Level	IP54
Input power	3PH 380VAC 50/60Hz
Transformer	3.0KVA (380V to 220V isolated transformer)
I/O signal	16-in / 16-out 24VDC; 2 analog output 0~10V
LAN	EtherCAT, TCP/IP
Serial port I/F	RS485*1, RS422*1, RS232*1, CAN*1, USB*1
RAM capacity	JOB 200,000 steps (200MB)

Installation environment

Ambient temperature	0~45°C
Humidity	20~80%RH, no condensing
Vibrations	Below 0.5G
Altitude	Below 1000m
Other requirements	<ul style="list-style-type: none"> ●With no corrosive or combustible gas ●With no water, oil or drug splashing ●With no electromagnetic field nearby ●With no radiations nearby

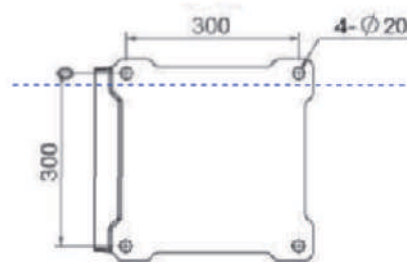
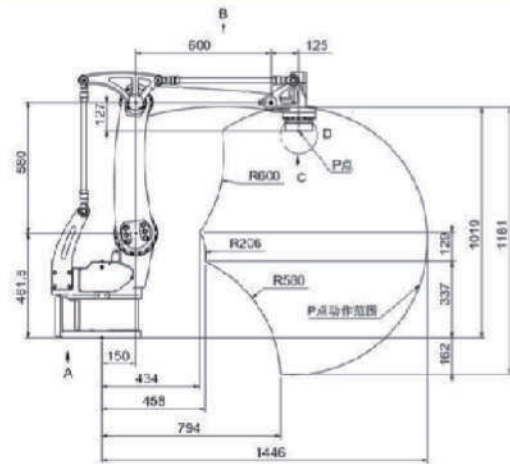

Base

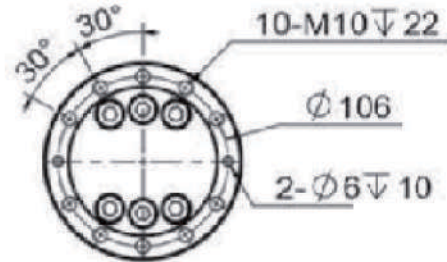

Flange

Robot specifications

Basic parameters	
Model No.	YSRH15-1400
Controlled axis	4-DOF
Max payload	15kg
Max stroke	1446mm
IP Level	J1,J2-IP54;J3,J4-IP65
Installation mode	Floor type
Robot mass	170kg
Repeatability	±0.08 mm
Applications	<ul style="list-style-type: none"> •Pick-n-place •Palletizing
Travel range	
J1 axis S	±170°
J2 axis L	+10°~ -125°
J3 axis U	+10°~ -95°
J4 axis R	±360°
Travel speed	
J1 axis S	190°/s
J2 axis L	120°/s
J3 axis U	120°/s
J4 axis R	200°/s

Installation environment

Ambient temperature	0~45°C
Humidity	20~80%RH, no condensing
Vibrations	Below 0.5G
Altitude	Below 1000m
Other requirements	<ul style="list-style-type: none"> •With no corrosive or combustible gas •With no water, oil or drug splashing •With no electromagnetic field nearby •With no radiations nearby

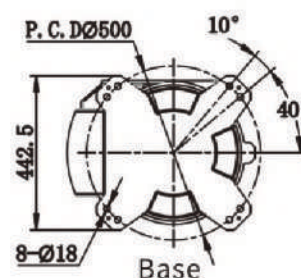
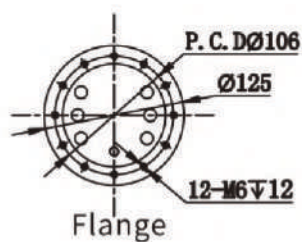
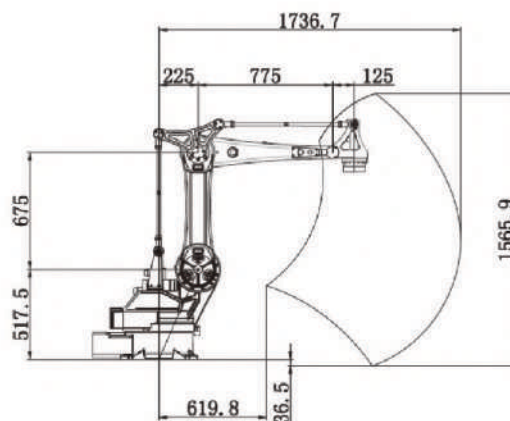

Robot specifications

Basic parameters	
Model No.	YSRT25B-180
Controlled axis	4-DOF
Max payload	25kg
Max stroke	1736mm
IP Level	J1, J2-IP56; J3, J4-IP65
Installation mode	Floor type, ceiling type
Robot mass	280 kg
Repeatability	±0.08 mm
Applications	<ul style="list-style-type: none"> •Pick-n-place •Palletizing
Travel range	
J1 axis S	±130°
J2 axis L	+120°~-20°
J3 axis U	+185°~-145°
J4 axis R	±360°
Travel speed	
J1 axis S	136°/s
J2 axis L	135°/s
J3 axis U	118°/s
J4 axis R	222°/s

Installation environment

Ambient temperature	0~45°C
Humidity	20~80%RH, no condensing
Vibrations	Below 0.5G
Altitude	Below 1000m
Other requirements	<ul style="list-style-type: none"> •With no corrosive or combustible gas •With no water, oil or drug splashing •With no electromagnetic field nearby •With no radiations nearby

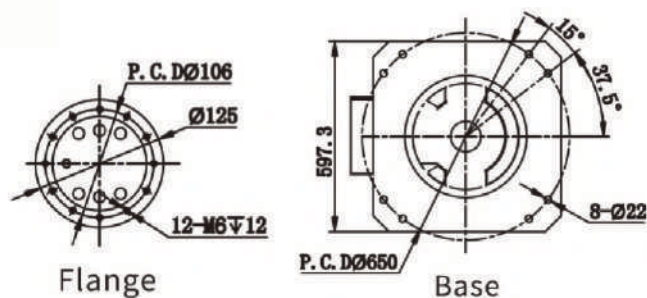
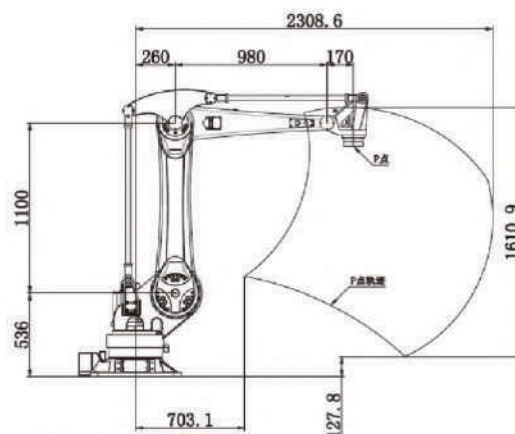

Robot specifications

Basic parameters	
Model No.	YSRT050B-230
Controlled axis	4-DOF
Max payload	50kg
Max stroke	2308mm
IP Level	J1, J2-IP56; J3, J4- IP65
Installation mode	Floor type, ceiling type
Robot mass	550kg
Repeatability	±0.15mm
Applications	<ul style="list-style-type: none"> ●Pick-n-place ●Palletizing
Travel range	
J1 axis S	±160°
J2 axis L	+130°~-40°
J3 axis U	+60°~-50°
J4 axis R	±360°
Travel speed	
J1 axis S	222°/s
J2 axis L	148°/s
J3 axis U	148°/s
J4 axis R	222°/s

Installation environment

Ambient temperature	0~45°C
Humidity	20~80%RH, no condensing
Vibrations	Below 0.5G
Altitude	Below 1000m
Other requirements	<ul style="list-style-type: none"> ●With no corrosive or combustible gas ●With no water, oil or drug splashing ●With no electromagnetic field nearby ●With no radiations nearby



4-AXIS HANDLING ROBOT

YSRT100B-230

Fast, accurate and reliable.

Suitable for pick-n-place and palletizing.

Robot specifications

Basic data	
Model No.	YSRT100B-230
Number of axes	4
Maximum payload	100 kg
Maximum stroke	2363mm
IP class	J1, J2 - IP56; J3, J4 - IP67
Mounting position	Floor type
Approx. weight	630 kg (without cabinet)
Repeatability	±0.08 mm
Internal air duct	Φ10
Motion range	
J1 axis S	±150°
J2 axis L	+35°~-55°
J3 axis U	+60°~-50°
J4 axis R	±360°
Speed with rated payload	
J1 axis S	127°/s
J2 axis L	70°/s
J3 axis U	74.5°/s
J4 axis R	222°/s

Electrical cabinet specifications	
Dimensions	560*500*730mm
Approx. weight	55KG
Cooling method	Natural cooling
Input power	380VAC 50/60Hz
Grounding	Industrial grounding (grounding resistance below 100Ω)
I/O terminals	<ul style="list-style-type: none"> • 16 digital inputs • 16 digital outputs
Position control mode	EtherCAT, TCP/IP
Serial port I/F	RS485*1, RS422*1, RS232*1, CAN*1, USB*1
RAM capacity	JOB 200,000 steps, 10,000 robot commands (200MB)
Driving unit	6-axis AC servo system. External axis can be added as an option.

Operating conditions	
Use temperature	0~45°C
Storage temperature	-20~60°C
Humidity	10~90% RH, no condensing
Vibrations	Below 0.5G
Altitude	Below 1000m. (Degrade if over 1000m, max 2000m)
Other requirements	<ul style="list-style-type: none"> • With no corrosive or combustible gas • With no water, oil or drug splashing • With no electromagnetic field nearby • With no radiations nearby

► Working envelope (unit: mm)

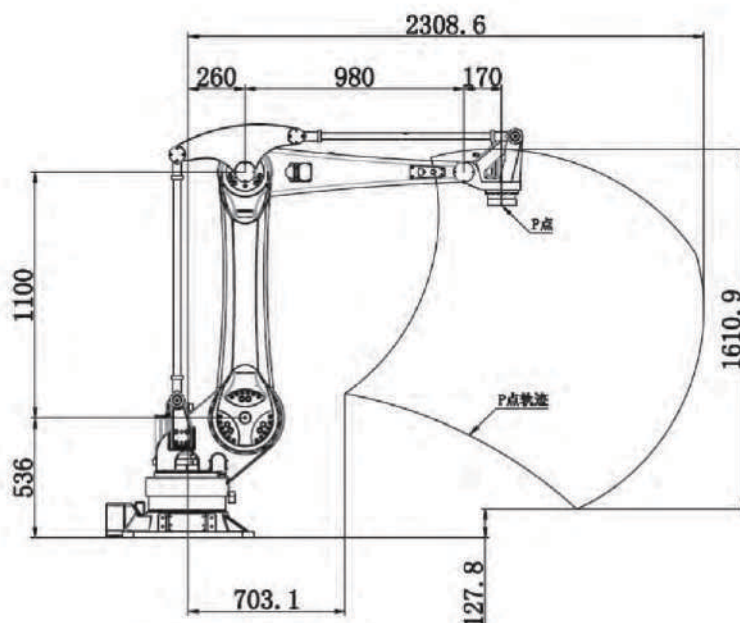

► Flange and base dimensions (unit: mm)

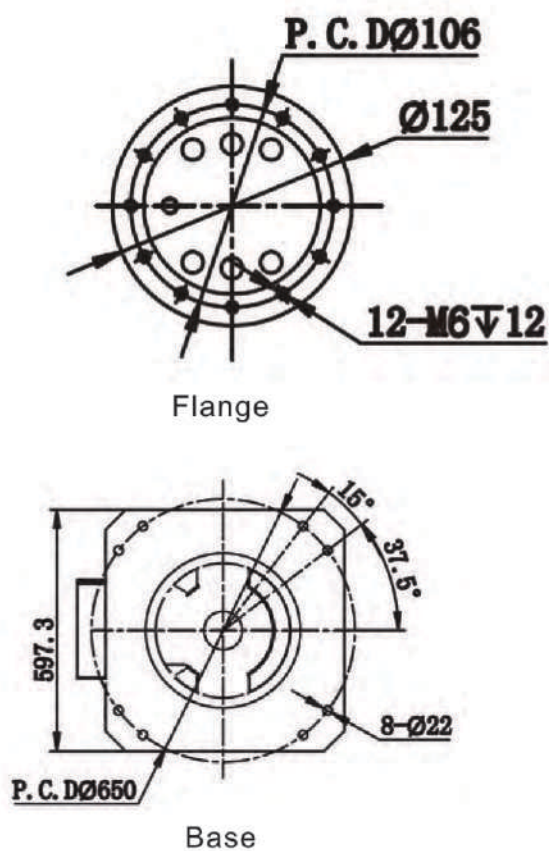

All data, drawings and specifications provided in this catalog are purely for information purposes and do not constitute a guarantee of these characteristics. The extent of goods delivered and services performed is determined by the subject matter of the specific contract. No liability accepted for errors or omissions.



4-AXIS HANDLING ROBOT

YS10B-1400

Fast, accurate and reliable.

Suitable for pick-n-place and palletizing.

Robot specifications

Basic data	
Model No.	YS10B-1400
Number of axes	4
Maximum payload	12 kg
Maximum stroke	1400mm
IP class	J1, J2 - IP56; J3, J4- IP67
Mounting position	Floor type
Approx. weight	165 kg (without cabinet)
Repeatability	±0.08 mm
Internal air duct	Φ10
Motion range	
J1 axis S	±170°
J2 axis L	+80°~-32°
J3 axis U	+20°~-90°
J4 axis R	±360°
Speed with rated payload	
J1 axis S	223°/s
J2 axis L	173°/s
J3 axis U	300°/s
J4 axis R	481°/s

Electrical cabinet specifications	
Dimensions	490*400*365mm
Approx. weight	40KG
Cooling method	Natural cooling
Input power	220VAC 50/60Hz
Grounding	Industrial grounding (grounding resistance below 100Ω)
I/O terminals	<ul style="list-style-type: none"> • 16 digital inputs • 16 digital outputs
Position control mode	EtherCAT, TCP/IP
Serial port I/F	RS485*1, RS422*1, RS232*1, CAN*1, USB*1
RAM capacity	JOB 200,000 steps, 10,000 robot commands (200MB)
Driving unit	6-axis AC servo system. External axis can be added as an option.

Operating conditions	
Use temperature	0~45°C
Storage temperature	-20~60°C
Humidity	10~90% RH, no condensing
Vibrations	Below 0.5G
Altitude	Below 1000m. (Degrade if over 1000m, max 2000m)
Other requirements	<ul style="list-style-type: none"> • With no corrosive or combustible gas • With no water, oil or drug splashing • With no electromagnetic field nearby • With no radiations nearby

► Working envelope (unit: mm)

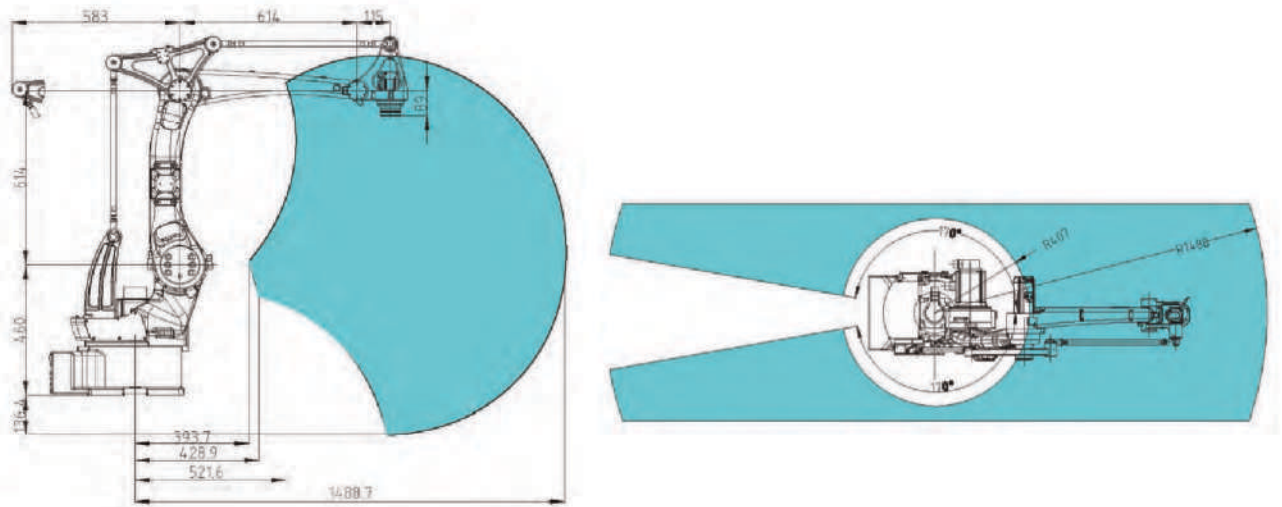

► Flange and base dimensions (unit: mm)

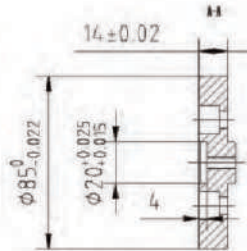
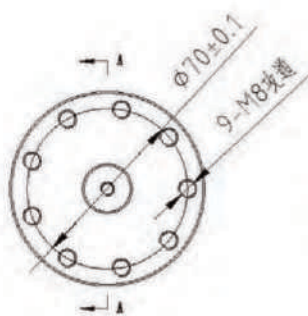

Flange

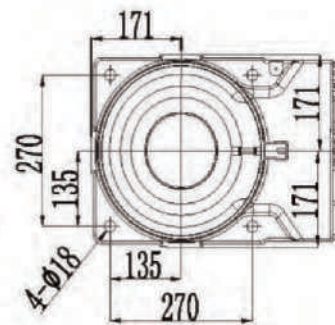

Base

► Payload diagram

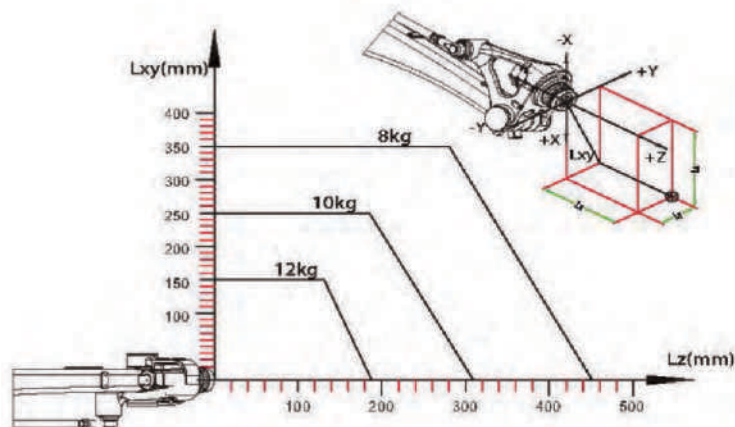

All data, drawings and specifications provided in this catalog are purely for information purposes and do not constitute a guarantee of these characteristics. The extent of goods delivered and services performed is determined by the subject matter of the specific contract. No liability accepted for errors or omissions.



4-AXIS HANDLING ROBOT

YS25B-1800

Fast, accurate and reliable.
Suitable for pick-n-place and palletizing.

Robot specifications

Basic data	
Model No.	YS25B-1800
Number of axes	4
Maximum payload	25 kg
Maximum stroke	1758mm
IP class	J1, J2 - IP56; J3, J4- IP67
Mounting position	Floor type
Approx. weight	295 kg (without cabinet)
Repeatability	±0.08 mm
Internal air duct	Φ10
Motion range	
J1 axis S	±130°
J2 axis L	+35°~-70°
J3 axis U	+75°~-70°
J4 axis R	±360°
Speed with rated payload	
J1 axis S	136°/s
J2 axis L	135°/s
J3 axis U	118°/s
J4 axis R	222°/s

Electrical cabinet specifications	
Dimensions	560*500*730mm
Approx. weight	50KG
Cooling method	Natural cooling
Input power	380VAC 50/60Hz
Grounding	Industrial grounding (grounding resistance below 100Ω)
I/O terminals	<ul style="list-style-type: none"> • 16 digital inputs • 16 digital outputs
Position control mode	EtherCAT, TCP/IP
Serial port I/F	RS485*1, RS422*1, RS232*1, CAN*1, USB*1
RAM capacity	JOB 200,000 steps, 10,000 robot commands (200MB)
Driving unit	6-axis AC servo system. External axis can be added as an option.

Operating conditions	
Use temperature	0~45°C
Storage temperature	-20~60°C
Humidity	10~90% RH, no condensing
Vibrations	Below 0.5G
Altitude	Below 1000m. (Degrade if over 1000m, max 2000m)
Other requirements	<ul style="list-style-type: none"> • With no corrosive or combustible gas • With no water, oil or drug splashing • With no electromagnetic field nearby • With no radiations nearby

► Working envelope (unit: mm)

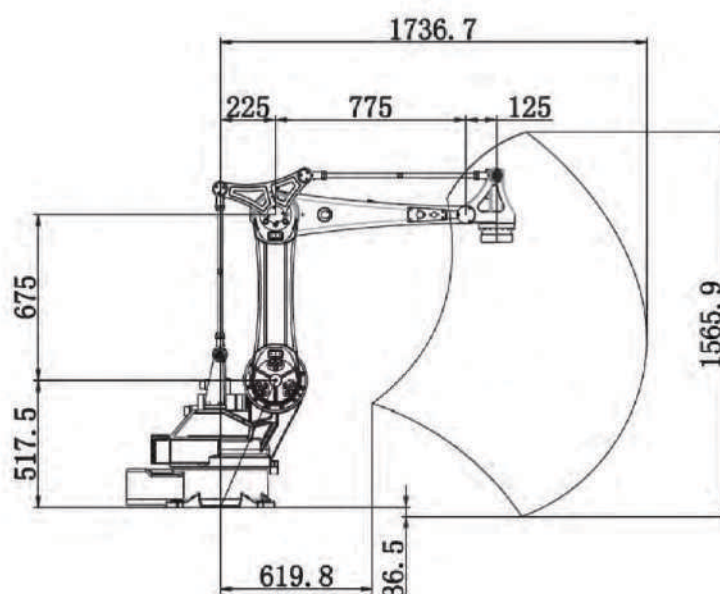

► Flange and base dimensions (unit: mm)

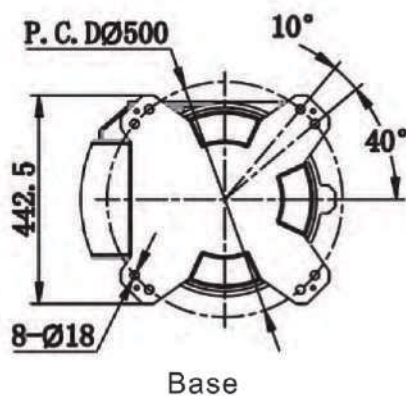
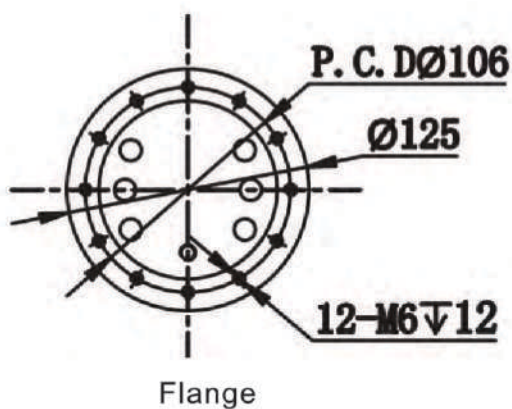

All data, drawings and specifications provided in this catalog are purely for information purposes and do not constitute a guarantee of these characteristics. The extent of goods delivered and services performed is determined by the subject matter of the specific contract. No liability accepted for errors or omissions.



4-AXIS HANDLING ROBOT

YS50B-2300

Fast, accurate and reliable.

Suitable for pick-n-place and palletizing.

Robot specifications

Basic data	
Model No.	YS50B-2300
Number of axes	4
Maximum payload	50 kg
Maximum stroke	2363mm
IP class	J1, J2 - IP56; J3, J4- IP67
Mounting position	Floor type
Approx. weight	615 kg (without cabinet)
Repeatability	±0.08 mm
Internal air duct	Φ10
Motion range	
J1 axis S	±150°
J2 axis L	+35°~-55°
J3 axis U	+60°~-50°
J4 axis R	±360°
Speed with rated payload	
J1 axis S	127°/s
J2 axis L	70°/s
J3 axis U	74.5°/s
J4 axis R	222°/s

Electrical cabinet specifications	
Dimensions	560*500*730mm
Approx. weight	55KG
Cooling method	Natural cooling
Input power	380VAC 50/60Hz
Grounding	Industrial grounding (grounding resistance below 100Ω)
I/O terminals	<ul style="list-style-type: none"> • 16 digital inputs • 16 digital outputs
Position control mode	EtherCAT, TCP/IP
Serial port I/F	RS485*1, RS422*1, RS232*1, CAN*1, USB*1
RAM capacity	JOB 200,000 steps, 10,000 robot commands (200MB)
Driving unit	6-axis AC servo system. External axis can be added as an option.

Operating conditions	
Use temperature	0~45°C
Storage temperature	-20~60°C
Humidity	10~90% RH, no condensing
Vibrations	Below 0.5G
Altitude	Below 1000m. (Degrade if over 1000m, max 2000m)
Other requirements	<ul style="list-style-type: none"> • With no corrosive or combustible gas • With no water, oil or drug splashing • With no electromagnetic field nearby • With no radiations nearby

► Working envelope (unit: mm)

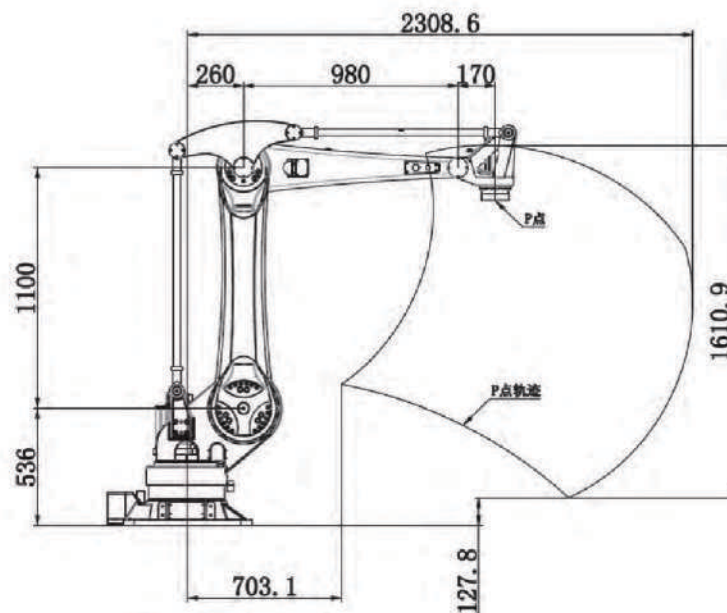

► Flange and base dimensions (unit: mm)

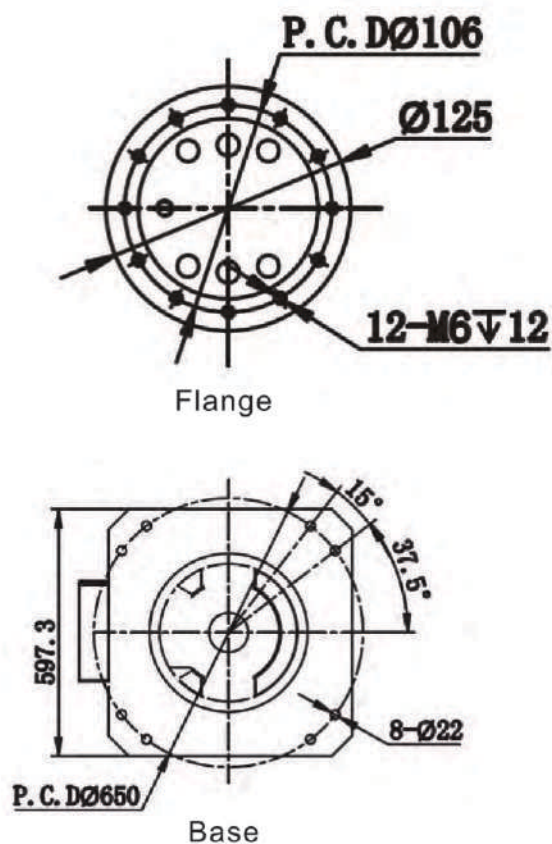

All data, drawings and specifications provided in this catalog are purely for information purposes and do not constitute a guarantee of these characteristics. The extent of goods delivered and services performed is determined by the subject matter of the specific contract. No liability accepted for errors or omissions.

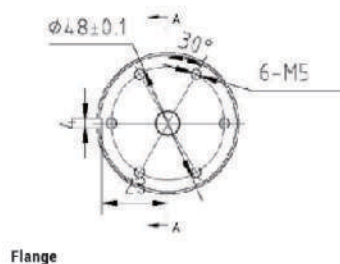
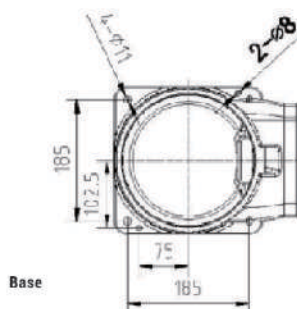
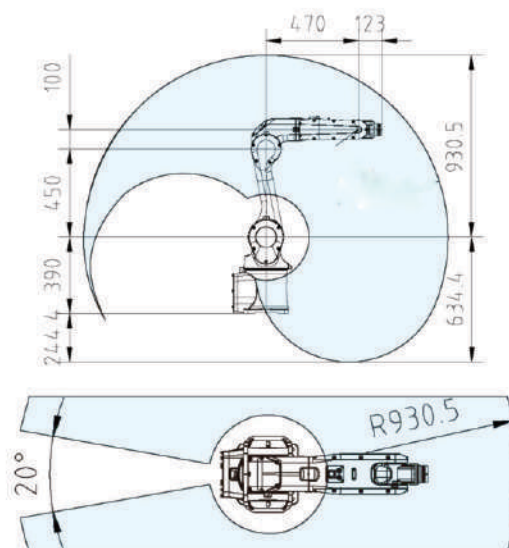

Robot specifications

Basic parameters	
Model No.	YS07-930
Controlled axis	6-DOF
Max payload	7kg
Max stroke	930mm
IP Level	J1,J2-IP56;J3,J4,J5,J6-IP67
Installation mode	Floor type, ceiling type
Robot mass	60kg
Repeatability	±0.05mm
Applications	Pick-n-place, Palletizing Painting
Travel range	
J1 axis S	±170°
J2 axis L	±110°
J3 axis U	+70°~ -90°
J4 axis R	±200°
J5 axis B	±120°
J6 axis T	±360°
Travel speed	
J1 axis S	262.5°/s
J2 axis L	262.5°/s
J3 axis U	267.5°/s
J4 axis R	326.5°/s
J5 axis B	375°/s
J6 axis T	600°/s

Electrical cabinet specifications

Dimensions	460*300*300mm
Cabinet Mass	20KG
Cooling method	Natural cooling
IP Level	IP54
Input power	220VAC, 1PH, 50/60Hz
Transformer	2.0KVA
I/O signal	16-in / 16-out 24VDC; 2 analog output 0~10V
LAN	EtherCAT, TCP/IP
Serial port I/F	RS485*1, RS422*1, RS232*1, CAN*1, USB*1
RAM capacity	JOB 200,000 steps (200MB)

Installation environment

Ambient temperature	0~45°C
Humidity	20~80%RH, no condensing
Vibrations	Below 0.5G
Altitude	Below 1000m
Other requirements	<ul style="list-style-type: none"> With no corrosive or combustible gas With no water, oil or drug splashing With no electromagnetic field nearby With no radiations nearby



6-AXIS HANDLING ROBOT

YS07-930

Enclosed design, compact and agile.
Suitable for pick-n-place, machine tending and palletizing.

Robot specifications

Basic data	
Model No.	YS07-930
Number of axes	6
Maximum payload	7 kg
Maximum stroke	930mm
IP class	J1, J2, J3, J4, J5, J6- IP67
Mounting position	Floor type, wall type, ceiling type
Approx. weight	60 kg (without cabinet)
Repeatability	±0.05 mm
Internal air duct	Φ6
Motion range	
J1 axis S	±170°
J2 axis L	±110°
J3 axis U	+70°~-90°
J4 axis R	±200°
J5 axis B	±120°
J6 axis T	±360°
Speed with rated payload	
J1 axis S	338 °/s
J2 axis L	219 °/s
J3 axis U	300 °/s
J4 axis R	262 °/s
J5 axis B	376 °/s
J6 axis T	600 °/s

Electrical cabinet specifications	
Dimensions	490*400*365mm
Approx. weight	40KG
Cooling method	Natural cooling
Input power	220VAC 50/60Hz
Grounding	Industrial grounding (grounding resistance below 100Ω)
I/O terminals	<ul style="list-style-type: none"> • 16 digital inputs • 16 digital outputs • 2 analog outputs (optional)
Position control mode	EtherCAT, TCP/IP
Serial port I/F	RS485*1, RS422*1, RS232*1, CAN*1, USB*1
RAM capacity	JOB 200,000 steps, 10,000 robot commands (200MB)
Driving unit	6-axis AC servo system. External axis can be added as an option.

Operating conditions	
Use temperature	0~45°C
Storage temperature	-20~60°C
Humidity	10~90% RH, no condensing
Vibrations	Below 0.5G
Altitude	Below 1000m. (Degrade if over 1000m, max 2000m)
Other requirements	<ul style="list-style-type: none"> • With no corrosive or combustible gas • With no water, oil or drug splashing • With no electromagnetic field nearby • With no radiations nearby

► Working envelope (unit: mm)

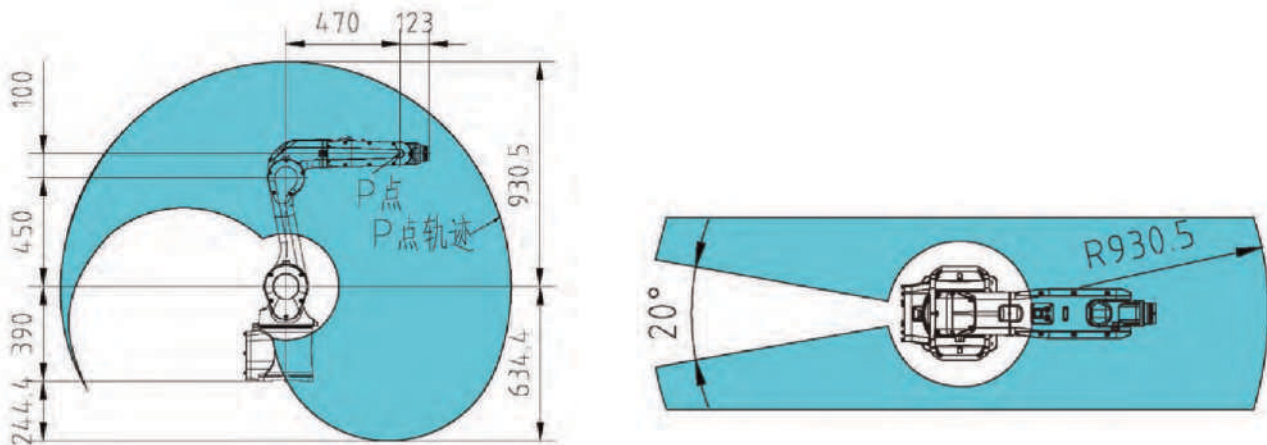

► Flange and base dimensions (unit: mm)

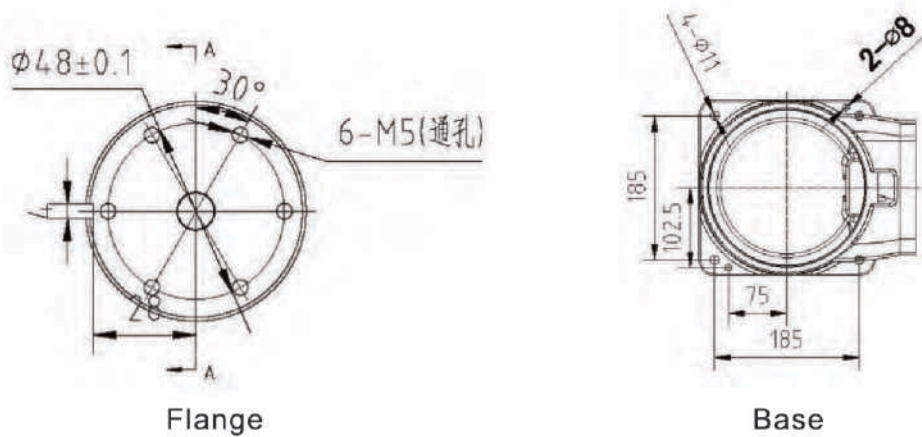

► Payload diagram

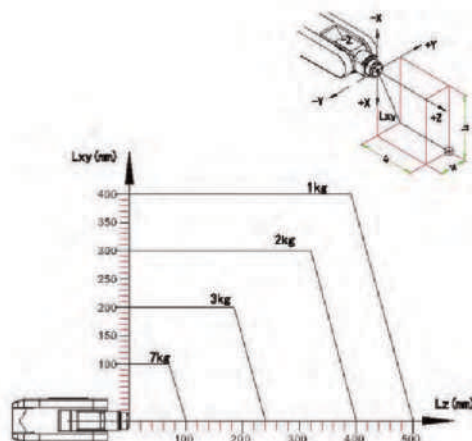

All data, drawings and specifications provided in this catalog are purely for information purposes and do not constitute a guarantee of these characteristics. The extent of goods delivered and services performed is determined by the subject matter of the specific contract. No liability accepted for errors or omissions.

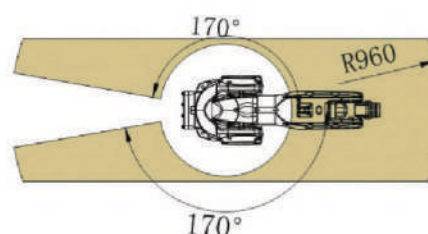
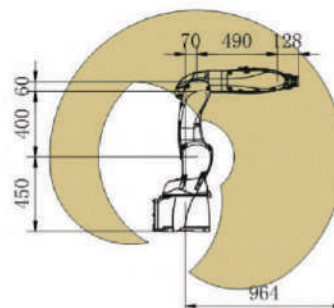

Robot specifications

Basic parameters	
Model No.	YS07-960
Controlled axis	6-DOF
Max payload	7 kg
Max stroke	964mm
IP Level	J1, J2-IP56; J3, J4, J5, J6- IP67
Installation mode	Floor type, ceiling type
Robot mass	60 kg
Repeatability	±0.02 mm
Applications	<ul style="list-style-type: none"> ●Pick-n-place ●Palletizing
Travel range	
J1 axis S	±170°
J2 axis L	+100°~135°
J3 axis U	+110°~115°
J4 axis R	±170°
J5 axis B	±120°
J6 axis T	±360°
Travel speed	
J1 axis S	286 °/s
J2 axis L	375 °/s
J3 axis U	297 °/s
J4 axis R	408.5 °/s
J5 axis B	370 °/s
J6 axis T	600 °/s

Electrical cabinet specifications

Dimensions	490*540*240mm
Cabinet Mass	30KG
Cooling method	Natural cooling
IP Level	IP54
Input power	3PH 380VAC 50/60Hz
Transformer	2.2KVA (380V to 220V isolated transformer)
I/O signal	16-in / 16-out 24VDC; 2 analog output 0~10V
LAN	EtherCAT, TCP/IP
Serial port I/F	RS485*1, RS422*1, RS232*1, CAN*1, USB*1
RAM capacity	JOB 200,000 steps (200MB)

Installation environment

Ambient temperature	0~45°C
Humidity	20~80%RH, no condensing
Vibrations	Below 0.5G
Altitude	Below 1000m
Other requirements	<ul style="list-style-type: none"> ●With no corrosive or combustible gas ●With no water, oil or drug splashing ●With no electromagnetic field nearby ●With no radiations nearby



6-AXIS HANDLING ROBOT

YS10-1440

Fast, accurate and reliable.

Suitable for pick-n-place, machine tending, palletizing and painting.

Robot specifications

Basic data	
Model No.	YS10-1440
Number of axes	6
Maximum payload	10 kg
Maximum stroke	1440mm
IP class	J1, J2 - IP56; J3, J4, J5, J6- IP67
Mounting position	Floor type, wall type, ceiling type
Approx. weight	172 kg (without cabinet)
Repeatability	±0.05 mm
Internal air duct	Φ10
Motion range	
J1 axis S	±160°
J2 axis L	+80°~-145°
J3 axis U	+145°~-75°
J4 axis R	±190°
J5 axis B	+50°~-210°
J6 axis T	±360°
Speed with rated payload	
J1 axis S	199.5°/s
J2 axis L	174 °/s
J3 axis U	199.5°/s
J4 axis R	392 °/s
J5 axis B	272 °/s
J6 axis T	480 °/s

Electrical cabinet specifications	
Dimensions	650*495*580mm
Approx. weight	60KG
Cooling method	Natural cooling
Input power	220VAC 50/60Hz
Grounding	Industrial grounding (grounding resistance below 100Ω)
I/O terminals	<ul style="list-style-type: none"> • 16 digital inputs • 16 digital outputs • 2 analog outputs (optional)
Position control mode	EtherCAT, TCP/IP
Serial port I/F	RS485*1, RS422*1, RS232*1, CAN*1, USB*1
RAM capacity	JOB 200,000 steps, 10,000 robot commands (200MB)
Driving unit	6-axis AC servo system. External axis can be added as an option.

Operating conditions	
Use temperature	0~45°C
Storage temperature	-20~60°C
Humidity	10~90% RH, no condensing
Vibrations	Below 0.5G
Altitude	Below 1000m. (Degrade if over 1000m, max 2000m)
Other requirements	<ul style="list-style-type: none"> • With no corrosive or combustible gas • With no water, oil or drug splashing • With no electromagnetic field nearby • With no radiations nearby

► Working envelope (unit: mm)

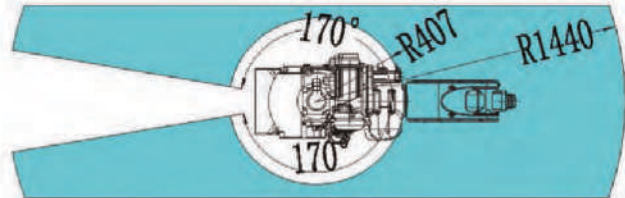
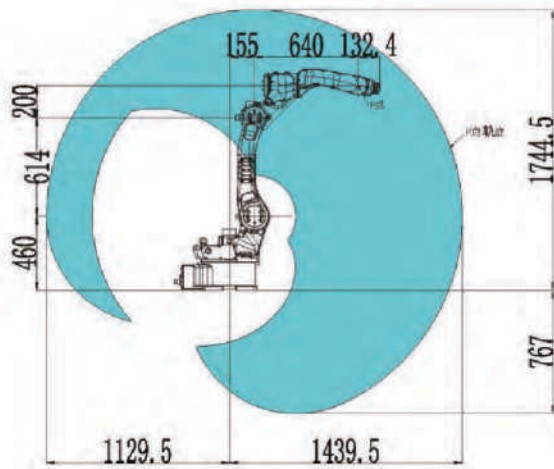

► Flange and base dimensions (unit: mm)

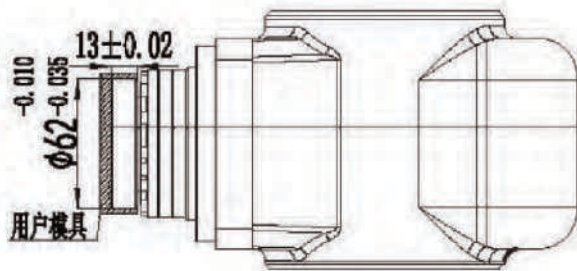

Flange

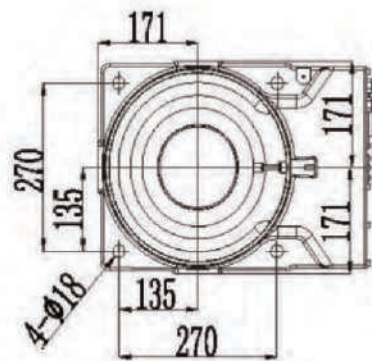

Base

► Payload diagram

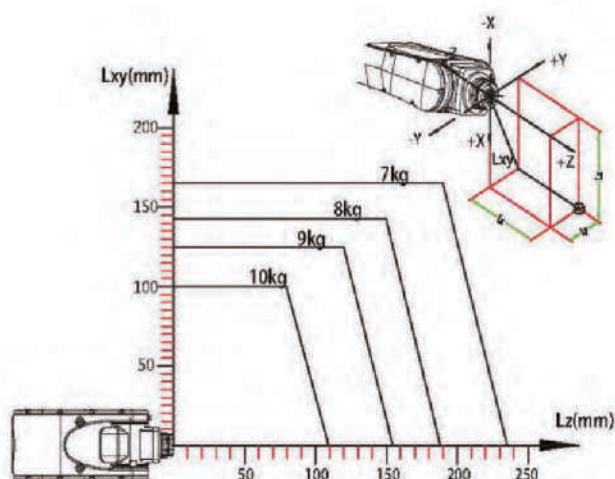

All data, drawings and specifications provided in this catalog are purely for information purposes and do not constitute a guarantee of these characteristics. The extent of goods delivered and services performed is determined by the subject matter of the specific contract. No liability accepted for errors or omissions.

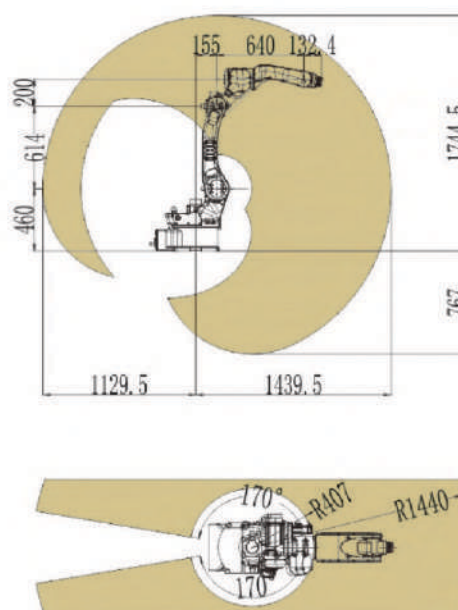

Robot specifications

Basic parameters	
Model No.	YS10Z-1440
Controlled axis	6-DOF
Max payload	10 kg
Max stroke	1440mm
IP Level	J1, J2-IP56; J3, J4, J5, J6-IP67
Installation mode	Floor type, ceiling type
Robot mass	172 kg
Repeatability	±0.05 mm
Applications	<ul style="list-style-type: none"> ●Pick-n-place / Palletizing ●Spraying / Packaging / Cutting
Travel range	
J1 axis S	±160°
J2 axis L	+80°~-145°
J3 axis U	+145°~-75°
J4 axis R	±190°
J5 axis B	±50°~-210°
J6 axis T	±360°
Travel speed	
J1 axis S	199.5°/s
J2 axis L	159.3°/s
J3 axis U	199.5°/s
J4 axis R	392°/s
J5 axis B	272°/s
J6 axis T	520°/s

Electrical cabinet specifications

Dimensions	600*500*590mm
Cabinet Mass	72KG
Cooling method	Natural cooling
IP Level	IP54
Input power	3PH 380VAC 50/60Hz
Transformer	4.5KVA (380V to 220V isolated transformer)
I/O signal	16-in / 16-out 24VDC; 2 analog output 0~10V
LAN	EtherCAT, TCP/IP
Serial port I/F	RS485*1, RS422*1, RS232*1, CAN*1, USB*1
RAM capacity	JOB 200,000 steps (200MB)

Installation environment

Ambient temperature	0~45°C
Humidity	20~80%RH, no condensing
Vibrations	Below 0.5G
Altitude	Below 1000m
Other requirements	<ul style="list-style-type: none"> ●With no corrosive or combustible gas ●With no water, oil or drug splashing ●With no electromagnetic field nearby ●With no radiations nearby



6-AXIS HANDLING ROBOT

YS10-2000

Special long-stroke design.
Suitable for pick-n-place and palletizing.

Robot specifications

Basic data	
Model No.	YS10-2000
Number of axes	6
Maximum payload	10 kg
Maximum stroke	2050mm
IP class	J1, J2 - IP56; J3, J4, J5, J6- IP67
Mounting position	Floor type, wall type, ceiling type
Approx. weight	260 kg (without cabinet)
Repeatability	±0.08 mm
Internal air duct	Φ10
Motion range	
J1 axis S	±167°
J2 axis L	+92°~150°
J3 axis U	+110°~85°
J4 axis R	±150°
J5 axis B	+20°~200°
J6 axis T	±360°
Speed with rated payload	
J1 axis S	154°/s
J2 axis L	154°/s
J3 axis U	162°/s
J4 axis R	296°/s
J5 axis B	333°/s
J6 axis T	333°/s

Electrical cabinet specifications	
Dimensions	650*495*580mm
Approx. weight	80KG
Cooling method	Natural cooling
Input power	380VAC 50/60Hz
Grounding	Industrial grounding (grounding resistance below 100Ω)
I/O terminals	<ul style="list-style-type: none"> • 16 digital inputs • 16 digital outputs • 2 analog outputs (optional)
Position control mode	EtherCAT, TCP/IP
Serial port I/F	RS485*1, RS422*1, RS232*1, CAN*1, USB*1
RAM capacity	JOB 200,000 steps, 10,000 robot commands (200MB)
Driving unit	6-axis AC servo system. External axis can be added as an option.

Operating conditions	
Use temperature	0~45°C
Storage temperature	-20~60°C
Humidity	10~90% RH, no condensing
Vibrations	Below 0.5G
Altitude	Below 1000m. (Degrade if over 1000m, max 2000m)
Other requirements	<ul style="list-style-type: none"> • With no corrosive or combustible gas • With no water, oil or drug splashing • With no electromagnetic field nearby • With no radiations nearby

► Working envelope (unit: mm)

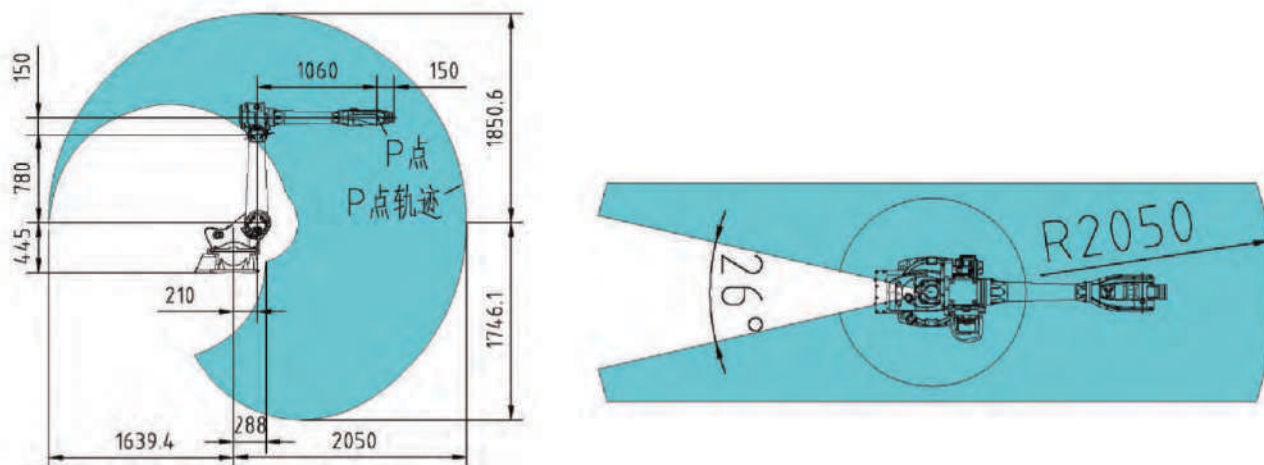

► Flange and base dimensions (unit: mm)

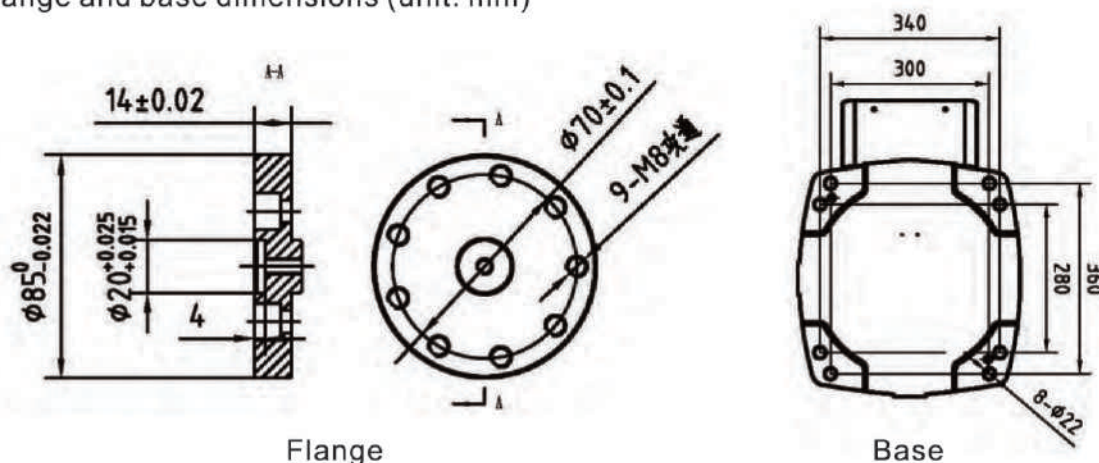

► Payload diagram

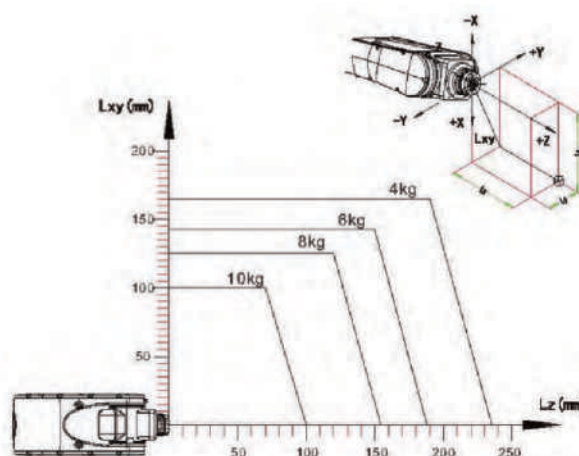

All data, drawings and specifications provided in this catalog are purely for information purposes and do not constitute a guarantee of these characteristics. The extent of goods delivered and services performed is determined by the subject matter of the specific contract. No liability accepted for errors or omissions.

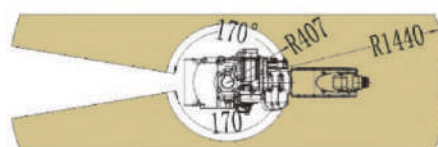
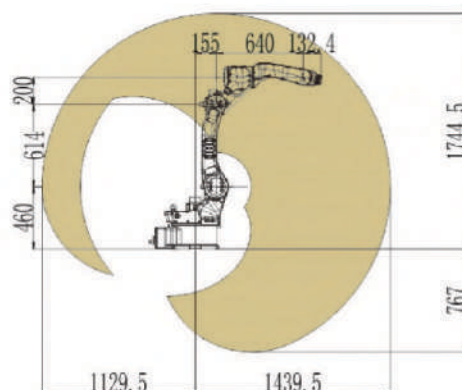

Robot specifications

Basic parameters	
Model No.	YS16Z-1440
Controlled axis	6-DOF
Max payload	16 kg
Max stroke	1440mm
IP Level	J1, J2-IP56; J3, J4, J5, J6- IP67
Installation mode	Floor type, ceiling type
Robot mass	175 kg
Repeatability	±0.05 mm
Applications	<ul style="list-style-type: none"> ●Pick-n-place / Palletizing ●Spraying / Packaging / Cutting
Travel range	
J1 axis S	±160°
J2 axis L	+80°~145°
J3 axis U	+145°~75°
J4 axis R	±190°
J5 axis B	±50°~210°
J6 axis T	±360°
Travel speed	
J1 axis S	199.5 °/s
J2 axis L	159.3°/s
J3 axis U	199.5°/s
J4 axis R	392°/s
J5 axis B	272°/s
J6 axis T	520°/s

Electrical cabinet specifications

Dimensions	600*500*590mm
Cabinet Mass	72KG
Cooling method	Natural cooling
IP Level	IP54
Input power	3PH 380VAC 50/60Hz
Transformer	4.5KVA (380V to 220V isolated transformer)
I/O signal	16-in / 16-out 24VDC; 2 analog output 0~10V
LAN	EtherCAT, TCP/IP
Serial port I/F	RS485*1, RS422*1, RS232*1, CAN*1, USB*1
RAM capacity	JOB 200,000 steps (200MB)

Installation environment

Ambient temperature	0~45°C
Humidity	20~80%RH, no condensing
Vibrations	Below 0.5G
Altitude	Below 1000m
Other requirements	<ul style="list-style-type: none"> ●With no corrosive or combustible gas ●With no water, oil or drug splashing ●With no electromagnetic field nearby ●With no radiations nearby

YS165B-3150

◆ Big Payload

The combination of 165kg payload and 2900mm arm length makes it easy to handle most robot automation works

◆ Easily maintained

Robot structure is simple, easy to install and convenient to maintain.

◆ High speed and stability

The optimized joint structure makes operation more fast and higher accuracy



Robot Applications

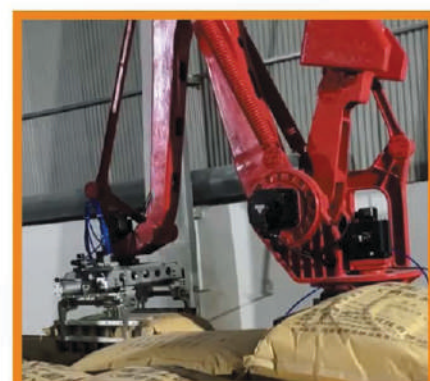

Robot Specifications

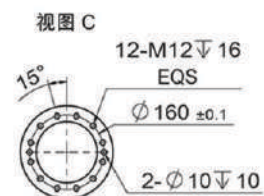
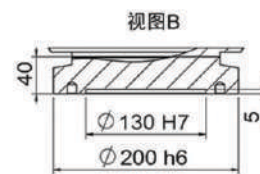
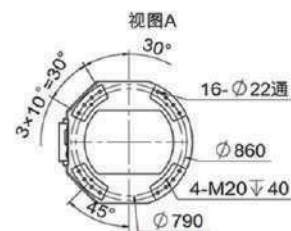
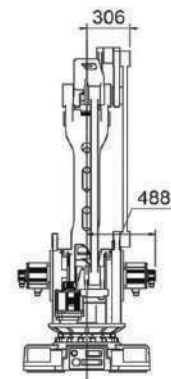
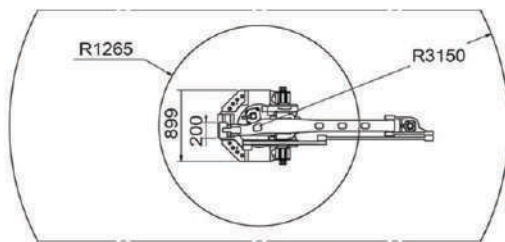
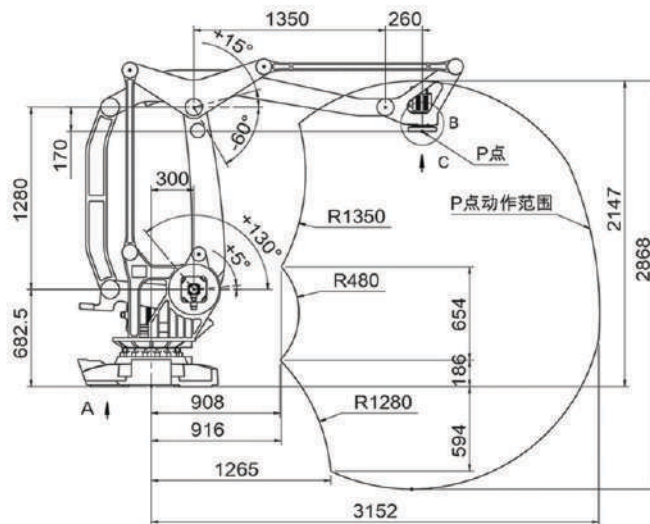
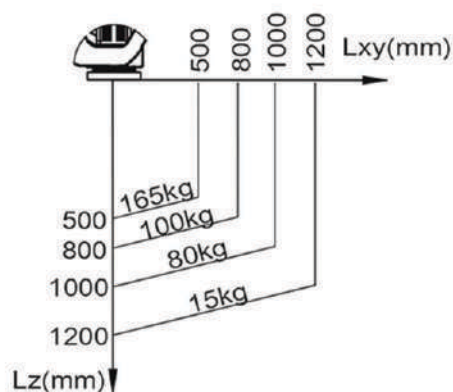
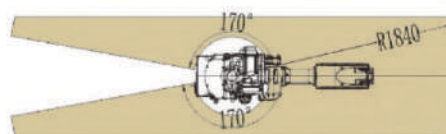
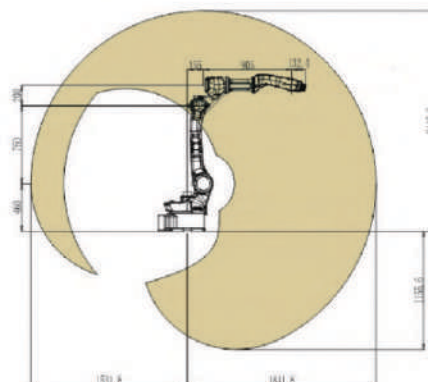

Diagram of load center and load mass curve



Item	Specification	Item	Specification	Axle	Motion Range	Max Speed	Hollow Axis Dia
Axis	4 Axis	Temperature	0°C — 45°C	J1	$\pm 180^\circ$	70° /S	—
Capacity	16.0KVA	Humidity	20% — 80%RH (No-humidity)	J2	+5° — +130°	82° /S	—
Body Weight	1500KG	Vibration	$\leq 4.9\text{M/S}^2$	J3	+15° — -60°	82° /S	—
Rated Payload	165KG	Others	No flammable and corrosive gases, liquids, away from electrical noise sources	J4	$\pm 360^\circ$	200° /S	—
Max Range	315CM						
Repeatability	$\pm 2\text{MM}$						
IP Grade	IP54						
Installation	Ground						



Robot specifications

Basic parameters	
Model No.	YS08Z-1840
Controlled axis	6-DOF
Max payload	8 kg
Max stroke	1840mm
IP Level	J1, J2-IP56; J3, J4, J5, J6- IP67
Installation mode	Floor type, ceiling type
Robot mass	180 kg
Repeatability	±0.05 mm
Applications	<ul style="list-style-type: none"> ●Pick-n-place / Palletizing ●Spraying / Packaging / Cutting
Travel range	
J1 axis S	±160°
J2 axis L	+80°~-145°
J3 axis U	+145°~-75°
J4 axis R	±190°
J5 axis B	±50°~-210°
J6 axis T	±360°
Travel speed	
J1 axis S	150°/s
J2 axis L	149°/s
J3 axis U	150°/s
J4 axis R	392°/s
J5 axis B	272°/s
J6 axis T	520°/s

Electrical cabinet specifications

Dimensions	600*500*590mm
Cabinet Mass	72KG
Cooling method	Natural cooling
IP Level	IP54
Input power	3PH 380VAC 50/60Hz
Transformer	4.5KVA (380V to 220V isolated transformer)
I/O signal	16-in / 16-out 24VDC; 2 analog output 0~10V
LAN	EtherCAT, TCP/IP
Serial port I/F	RS485*1, RS422*1, RS232*1, CAN*1, USB*1
RAM capacity	JOB 200,000 steps (200MB)

Installation environment

Ambient temperature	0~45°C
Humidity	20~80%RH, no condensing
Vibrations	Below 0.5G
Altitude	Below 1000m
Other requirements	<ul style="list-style-type: none"> ●With no corrosive or combustible gas ●With no water, oil or drug splashing ●With no electromagnetic field nearby ●With no radiations nearby

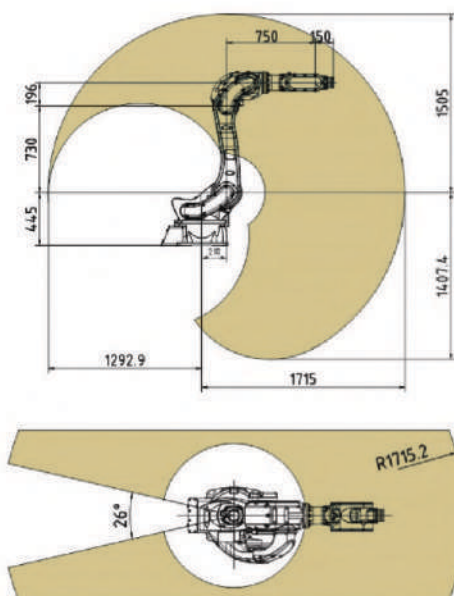

Robot specifications

Basic parameters	
Model No.	YS30-1700-H
Controlled axis	6-DOF
Max payload	30 kg
Max stroke	1715mm
IP Level	J1, J2-IP56; J3, J4, J5, J6- IP67
Installation mode	Floor type, ceiling type
Robot mass	280 kg
Repeatability	±0.08 mm
Applications	<ul style="list-style-type: none"> ●Pick-n-place / Palletizing ●Spraying / Packaging / Cutting
Travel range	
J1 axis S	±160°
J2 axis L	+80°~145°
J3 axis U	+145°~75°
J4 axis R	±190°
J5 axis B	±50°~210°
J6 axis T	±360°
Travel speed	
J1 axis S	189 °/s
J2 axis L	130 °/s
J3 axis U	148 °/s
J4 axis R	319 °/s
J5 axis B	297 °/s
J6 axis T	375 °/s

Electrical cabinet specifications

Dimensions	600*500*590mm
Cabinet Mass	72KG
Cooling method	Natural cooling
IP Level	IP54
Input power	3PH 380VAC 50/60Hz
Transformer	6.0KVA (380V to 220V isolated transformer)
I/O signal	16-in / 16-out 24VDC; 2 analog output 0~10V
LAN	EtherCAT, TCP/IP
Serial port I/F	RS485*1, RS422*1, RS232*1, CAN*1, USB*1
RAM capacity	JOB 200,000 steps (200MB)

Installation environment

Ambient temperature	0~45°C
Humidity	20~80%RH, no condensing
Vibrations	Below 0.5G
Altitude	Below 1000m
Other requirements	<ul style="list-style-type: none"> ●With no corrosive or combustible gas ●With no water, oil or drug splashing ●With no electromagnetic field nearby ●With no radiations nearby



6-AXIS HANDLING ROBOT

YS30-1700

Enclosed design. Heavy duty.

Suitable for pick-n-place, machine tending, palletizing, polishing and painting.

Robot specifications

Basic data	
Model No.	YS30-1700
Number of axes	6
Maximum payload	30 kg
Maximum stroke	1700mm
IP class	J1, J2 - IP56; J3, J4, J5, J6- IP67
Mounting position	Floor type, wall type, ceiling type
Approx. weight	283 kg (without cabinet)
Repeatability	±0.08 mm
Internal air duct	Φ10
Motion range	
J1 axis S	±165°
J2 axis L	+80°~150°
J3 axis U	+130°~60°
J4 axis R	±190°
J5 axis B	+20°~200°
J6 axis T	±360°
Speed with rated payload	
J1 axis S	130 °/s
J2 axis L	130 °/s
J3 axis U	144 °/s
J4 axis R	224 °/s
J5 axis B	333 °/s
J6 axis T	374 °/s

Electrical cabinet specifications	
Dimensions	650*495*580mm
Approx. weight	80KG
Cooling method	Natural cooling
Input power	380VAC 50/60Hz
Grounding	Industrial grounding (grounding resistance below 100Ω)
I/O terminals	<ul style="list-style-type: none"> • 16 digital inputs • 16 digital outputs • 2 analog outputs (optional)
Position control mode	EtherCAT, TCP/IP
Serial port I/F	RS485*1, RS422*1, RS232*1, CAN*1, USB*1
RAM capacity	JOB 200,000 steps, 10,000 robot commands (200MB)
Driving unit	6-axis AC servo system. External axis can be added as an option.

Operating conditions	
Use temperature	0~45°C
Storage temperature	-20~60°C
Humidity	10~90% RH, no condensing
Vibrations	Below 0.5G
Altitude	Below 1000m. (Degrade if over 1000m, max 2000m)
Other requirements	<ul style="list-style-type: none"> • With no corrosive or combustible gas • With no water, oil or drug splashing • With no electromagnetic field nearby • With no radiations nearby

► Working envelope (unit: mm)

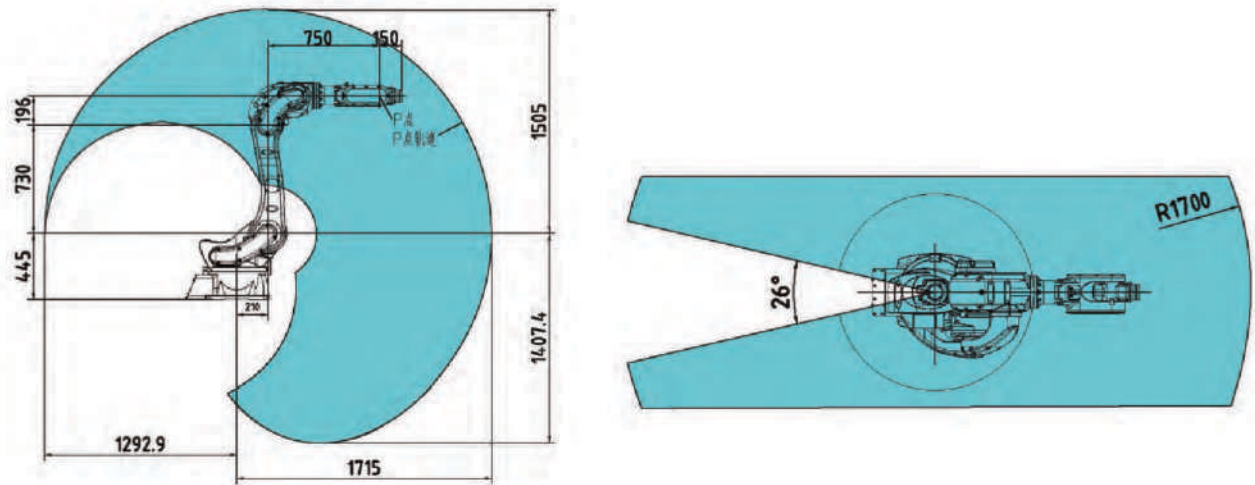

► Flange and base dimensions (unit: mm)

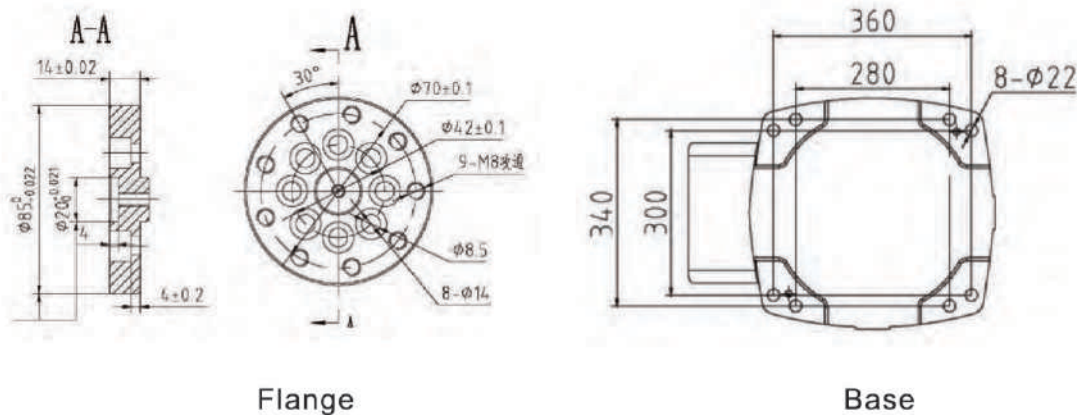

► Payload diagram

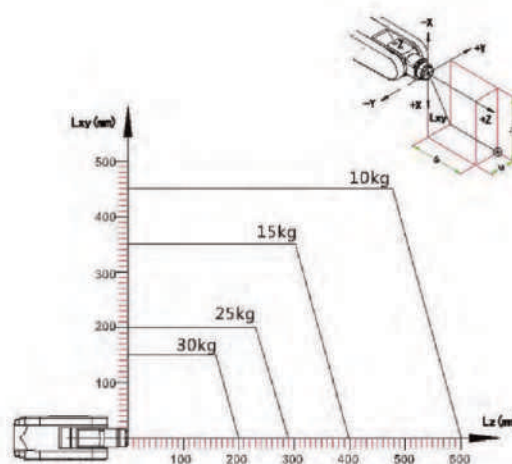

All data, drawings and specifications provided in this catalog are purely for information purposes and do not constitute a guarantee of these characteristics. The extent of goods delivered and services performed is determined by the subject matter of the specific contract. No liability accepted for errors or omissions.

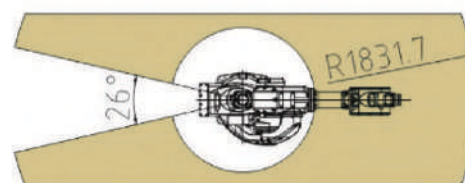
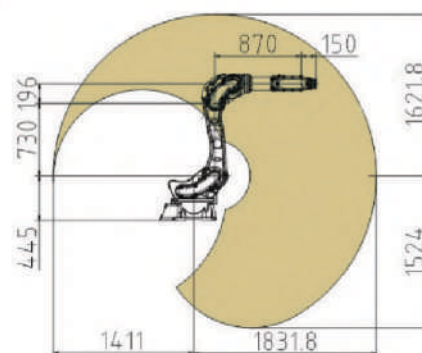

Robot specifications

Basic parameters	
Model No.	YS20-1800-H
Controlled axis	6-DOF
Max payload	20 kg
Max stroke	1831mm
IP Level	J1, J2-IP56; J3, J4, J5, J6- IP67
Installation mode	Floor type, ceiling type
Robot mass	283 kg
Repeatability	±0.08 mm
Applications	<ul style="list-style-type: none"> ●Pick-n-place / Palletizing ●Spraying / Packaging / Cutting
Travel range	
J1 axis S	±160°
J2 axis L	+80°~-145°
J3 axis U	+145°~-75°
J4 axis R	±190°
J5 axis B	±50°~-210°
J6 axis T	±360°
Travel speed	
J1 axis S	189 °/s
J2 axis L	130 °/s
J3 axis U	148 °/s
J4 axis R	319 °/s
J5 axis B	297 °/s
J6 axis T	375 °/s

Electrical cabinet specifications

Dimensions	600*500*590mm
Cabinet Mass	72KG
Cooling method	Natural cooling
IP Level	IP54
Input power	3PH 380VAC 50/60Hz
Transformer	6.0KVA (380V to 220V isolated transformer)
I/O signal	16-in / 16-out 24VDC; 2 analog output 0~10V
LAN	EtherCAT, TCP/IP
Serial port I/F	RS485*1, RS422*1, RS232*1, CAN*1, USB*1
RAM capacity	JOB 200,000 steps (200MB)

Installation environment

Ambient temperature	0~45℃
Humidity	20~80%RH, no condensing
Vibrations	Below 0.5G
Altitude	Below 1000m
Other requirements	<ul style="list-style-type: none"> ●With no corrosive or combustible gas ●With no water, oil or drug splashing ●With no electromagnetic field nearby ●With no radiations nearby



6-AXIS HANDLING ROBOT

YS20-1800

Fast, accurate and reliable.

Suitable for pick-n-place, machine tending, palletizing and painting.

Robot specifications

Basic data	
Model No.	YS20-1800
Number of axes	6
Maximum payload	20 kg
Maximum stroke	1840mm
IP class	J1, J2 - IP56; J3, J4, J5, J6- IP67
Mounting position	Floor type, wall type, ceiling type
Approx. weight	260 kg (without cabinet)
Repeatability	±0.08 mm
Internal air duct	Φ10
Motion range	
J1 axis S	±167°
J2 axis L	+92°~-150°
J3 axis U	+110°~-85°
J4 axis R	±150°
J5 axis B	+20°~-200°
J6 axis T	±360°
Speed with rated payload	
J1 axis S	200°/s
J2 axis L	198°/s
J3 axis U	163°/s
J4 axis R	296°/s
J5 axis B	333°/s
J6 axis T	333°/s

Electrical cabinet specifications	
Dimensions	650*495*580mm
Approx. weight	80KG
Cooling method	Natural cooling
Input power	380VAC 50/60Hz
Grounding	Industrial grounding (grounding resistance below 100Ω)
I/O terminals	<ul style="list-style-type: none"> • 16 digital inputs • 16 digital outputs • 2 analog outputs (optional)
Position control mode	EtherCAT, TCP/IP
Serial port I/F	RS485*1, RS422*1, RS232*1, CAN*1, USB*1
RAM capacity	JOB 200,000 steps, 10,000 robot commands (200MB)
Driving unit	6-axis AC servo system. External axis can be added as an option.

Operating conditions	
Use temperature	0~45°C
Storage temperature	-20~60°C
Humidity	10~90% RH, no condensing
Vibrations	Below 0.5G
Altitude	Below 1000m. (Degrade if over 1000m, max 2000m)
Other requirements	<ul style="list-style-type: none"> • With no corrosive or combustible gas • With no water, oil or drug splashing • With no electromagnetic field nearby • With no radiations nearby

► Working envelope (unit: mm)

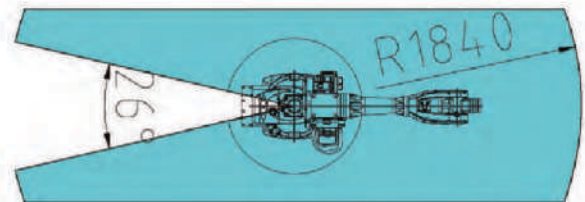
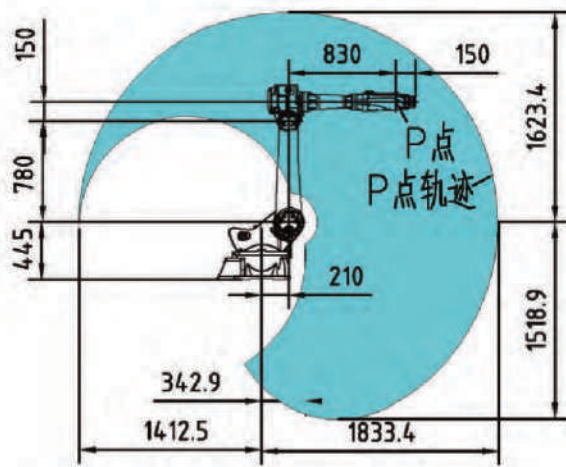

► Flange and base dimensions (unit: mm)

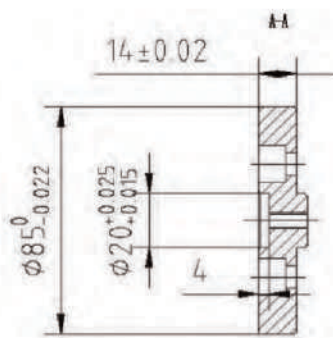

Flange

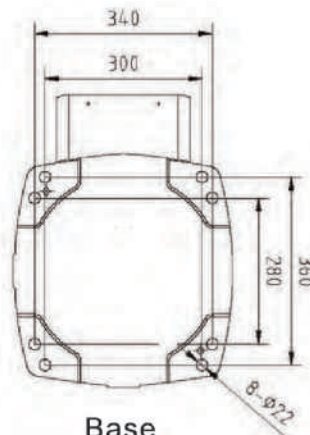
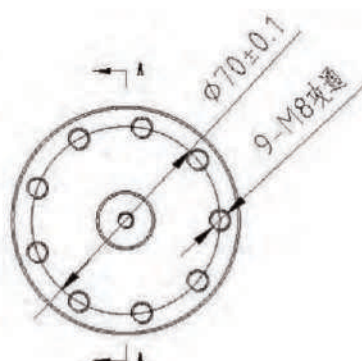

Base

► Payload diagram

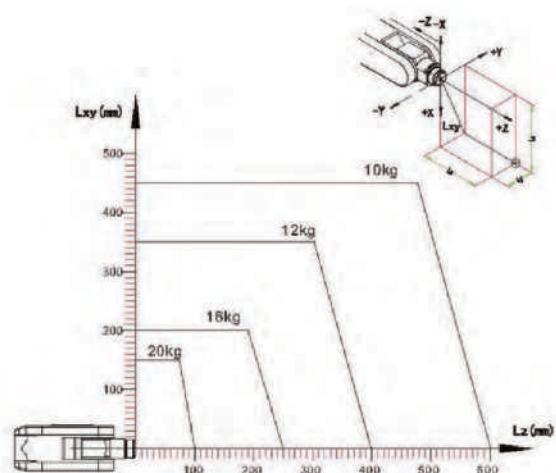

All data, drawings and specifications provided in this catalog are purely for information purposes and do not constitute a guarantee of these characteristics. The extent of goods delivered and services performed is determined by the subject matter of the specific contract. No liability accepted for errors or omissions.

6-Axis Handling Robot

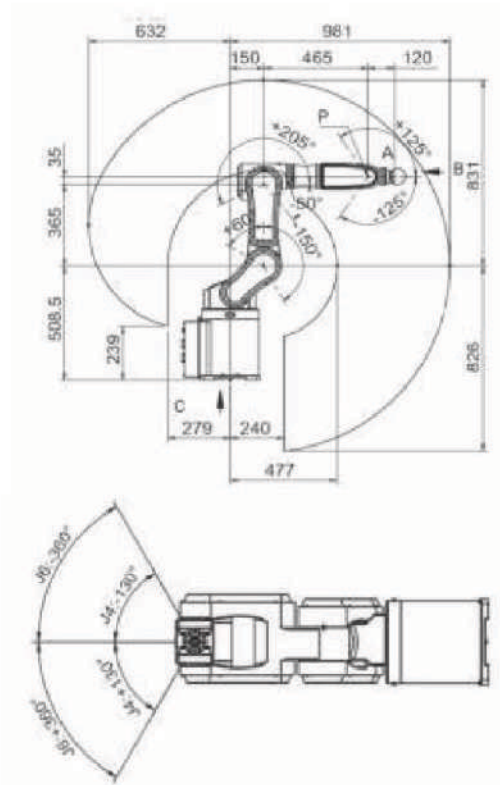
YS03H-980

Robot specifications

Basic parameters	
Model No.	YS03H-980
Controlled axis	6-DOF
Max payload	3 kg
Max stroke	980 mm
IP Level	J1, J2-IP56; J3, J4, J5, J6-- IP67
Installation mode	Floor type, ceiling type
Robot mass	63 kg
Repeatability	±0.03 mm
Applications	Handling, palletizing
Travel range	
J1 axis S	±170°
J2 axis L	+60°~-50°
J3 axis U	+205°~-50°
J4 axis R	±130°
J5 axis B	±125°
J6 axis T	±360°
Travel speed	
J1 axis S	145 °/s
J2 axis L	133 °/s
J3 axis U	140 °/s
J4 axis R	172 °/s
J5 axis B	172 °/s
J6 axis T	210 °/s

Electrical cabinet specifications

Dimensions	600*400*300mm
Cabinet Mass	35KG
Cooling method	Natural cooling
IP Level	IP54
Input power	3PH 380VAC 50/60Hz
Transformer	1.6KVA
I/O signal	16-in / 16-out 24VDC; 2 analog output 0~10V
LAN	EtherCAT, TCP/IP

Installation environment

Ambient temperature	0~45°C
Humidity	20~80%RH, no condensing
Vibrations	Below 0.5G
Altitude	Below 1000m
Other requirements	<ul style="list-style-type: none"> •With no corrosive or combustible gas •With no water, oil or drug splashing •With no electromagnetic field nearby •With no radiations nearby

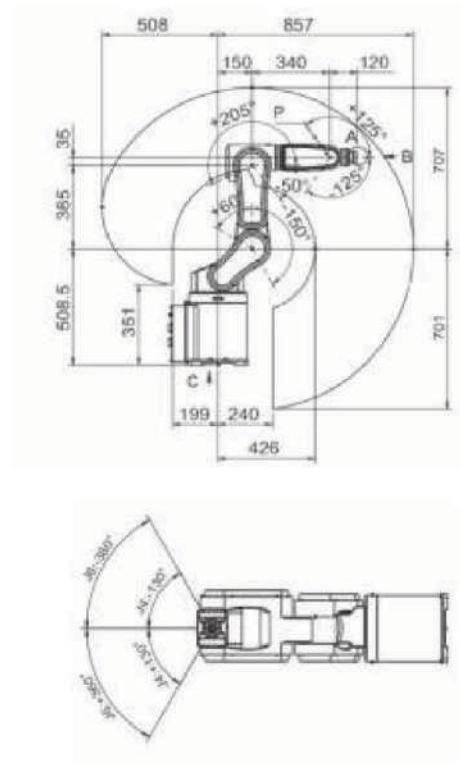

Robot specifications

Basic parameters	
Model No.	YS05H-850
Controlled axis	6-DOF
Max payload	5 kg
Max stroke	850 mm
IP Level	J1, J2-IP56; J3, J4, J5, J6-- IP67
Installation mode	Floor type, ceiling type
Robot mass	60 kg
Repeatability	±0.03 mm
Applications	Handling, palletizing
Travel range	
J1 axis S	±170°
J2 axis L	+60°~-50°
J3 axis U	+205°~-50°
J4 axis R	±130°
J5 axis B	±125°
J6 axis T	±360°
Travel speed	
J1 axis S	145 °/s
J2 axis L	133 °/s
J3 axis U	140 °/s
J4 axis R	172 °/s
J5 axis B	172 °/s
J6 axis T	210 °/s

Electrical cabinet specifications

Dimensions	600*400*300mm
Cabinet Mass	35KG
Cooling method	Natural cooling
IP Level	IP54
Input power	3PH 380VAC 50/60Hz
Transformer	1.6KVA
I/O signal	16-in / 16-out 24VDC; 2 analog output 0~10V
LAN	EtherCAT, TCP/IP

Installation environment

Ambient temperature	0~45°C
Humidity	20~80%RH, no condensing
Vibrations	Below 0.5G
Altitude	Below 1000m
Other requirements	<ul style="list-style-type: none"> •With no corrosive or combustible gas •With no water, oil or drug splashing •With no electromagnetic field nearby •With no radiations nearby

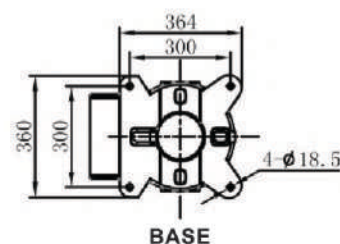
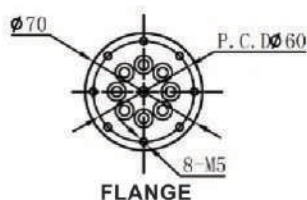
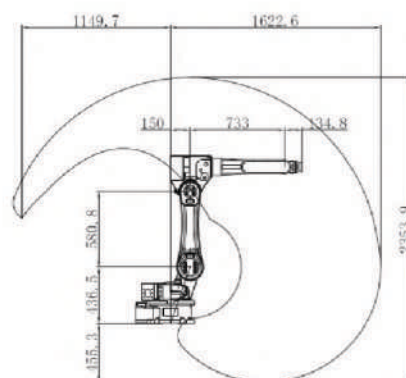
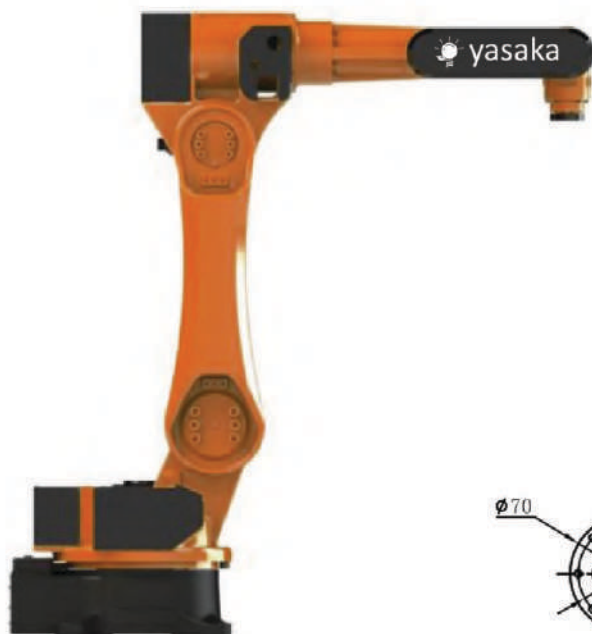

Robot specifications

Basic parameters	
Model No.	YSRT10A-160
Controlled axis	6-DOF
Max payload	10 kg
Max stroke	1622 mm
IP Level	J1, J2-IP56; J3, J4, J5, J6-IP67
Installation mode	Floor type, ceiling type
Robot mass	180 kg
Repeatability	±0.08 mm
Applications	<ul style="list-style-type: none"> ●Pick-n-place / Palletizing ●Spraying / Packaging / Cutting
Travel range	
J1 axis S	±140°
J2 axis L	+60°~90°
J3 axis U	+90°~60°
J4 axis R	±180°
J5 axis B	-115°~90°
J6 axis T	±360°
Travel speed	
J1 axis S	148 °/s
J2 axis L	148 °/s
J3 axis U	222 °/s
J4 axis R	225 °/s
J5 axis B	150 °/s
J6 axis T	320 °/s

Installation environment

Ambient temperature	0~45°C
Humidity	20~80%RH, no condensing
Vibrations	Below 0.5G
Altitude	Below 1000m
Other requirements	<ul style="list-style-type: none"> ●With no corrosive or combustible gas ●With no water, oil or drug splashing ●With no electromagnetic field nearby ●With no radiations nearby

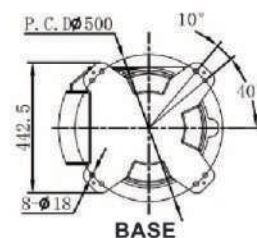
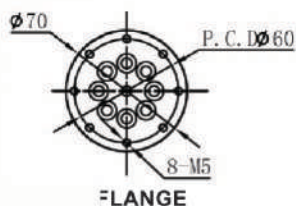
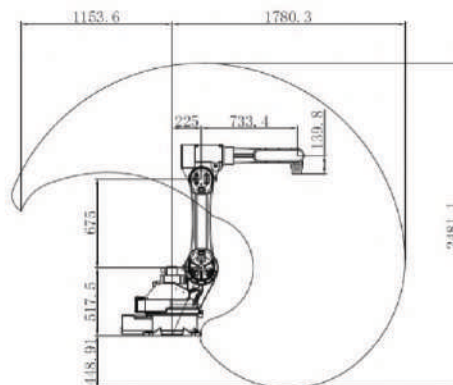

Robot specifications

Basic parameters	
Model No.	YSRT20A-178
Controlled axis	6-DOF
Max payload	20 kg
Max stroke	1780 mm
IP Level	J1, J2-IP56; J3, J4, J5, J6-IP67
Installation mode	Floor type, ceiling type
Robot mass	300 kg
Repeatability	±0.08 mm
Applications	<ul style="list-style-type: none"> ●Pick-n-place / Palletizing ●Spraying / Packaging / Cutting
Travel range	
J1 axis S	±145°
J2 axis L	+90°~-60°
J3 axis U	+80°~-80°
J4 axis R	±180°
J5 axis B	±110°
J6 axis T	±360°
Travel speed	
J1 axis S	136 °/s
J2 axis L	135 °/s
J3 axis U	118 °/s
J4 axis R	222 °/s
J5 axis B	300 °/s
J6 axis T	450 °/s

Installation environment

Ambient temperature	0~45°C
Humidity	20~80%RH, no condensing
Vibrations	Below 0.5G
Altitude	Below 1000m
Other requirements	<ul style="list-style-type: none"> ●With no corrosive or combustible gas ●With no water, oil or drug splashing ●With no electromagnetic field nearby ●With no radiations nearby

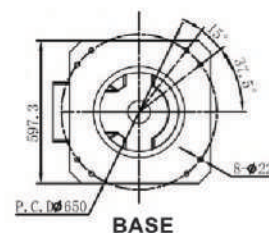
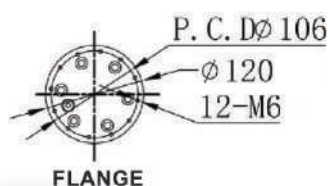
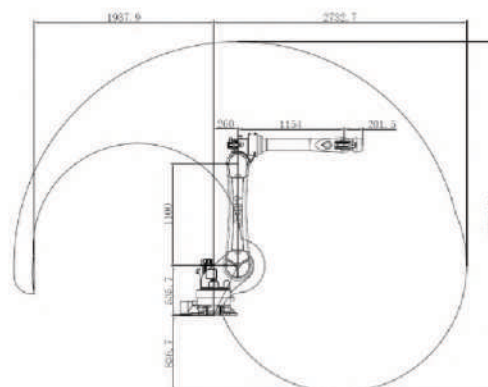

Robot specifications

Basic parameters	
Model No.	YSRT50A-270
Controlled axis	6-DOF
Max payload	50 kg
Max stroke	2732 mm
IP Level	J1, J2-IP56; J3, J4, J5, J6- IP67
Installation mode	Floor type, ceiling type
Robot mass	680 kg
Repeatability	±0.15 mm
Applications	<ul style="list-style-type: none"> ● Pick-n-place / Palletizing ● Spraying / Packaging / Cutting
Travel range	
J1 axis S	±165°
J2 axis L	+80°~-90°
J3 axis U	+105°~-75°
J4 axis R	±180°
J5 axis B	+98°~-90°
J6 axis T	±360°
Travel speed	
J1 axis S	127 °/s
J2 axis L	70 °/s
J3 axis U	74.5 °/s
J4 axis R	137 °/s
J5 axis B	99 °/s
J6 axis T	222 °/s

Installation environment

Ambient temperature	0~45°C
Humidity	20~80%RH, no condensing
Vibrations	Below 0.5G
Altitude	Below 1000m
Other requirements	<ul style="list-style-type: none"> ● With no corrosive or combustible gas ● With no water, oil or drug splashing ● With no electromagnetic field nearby ● With no radiations nearby



6-AXIS HANDLING ROBOT

YSRT50-270

Special long-stroke design.

Suitable for pick-n-place and palletizing.

Robot specifications

Basic data	
Model No.	YSRT50-270
Number of axes	6
Maximum payload	50 kg
Maximum stroke	1700mm
IP class	J1, J2 - IP56; J3, J4, J5, J6- IP67
Mounting position	Floor type
Approx. weight	600 kg (without cabinet)
Repeatability	±0.15 mm
Internal air duct	Φ10
Motion range	
J1 axis S	±165°
J2 axis L	+80°~-90°
J3 axis U	+105°~-75°
J4 axis R	±180°
J5 axis B	+98°~-90°
J6 axis T	±360°
Speed with rated payload	
J1 axis S	127°/s
J2 axis L	70 °/s
J3 axis U	74.5°/s
J4 axis R	137°/s
J5 axis B	99 °/s
J6 axis T	222 °/s

Electrical cabinet specifications	
Dimensions	560*500*730mm
Approx. weight	80KG
Cooling method	Natural cooling
Input power	380VAC 50/60Hz
Grounding	Industrial grounding (grounding resistance below 100Ω)
I/O terminals	<ul style="list-style-type: none"> • 16 digital inputs • 16 digital outputs • 2 analog outputs (optional)
Position control mode	EtherCAT, TCP/IP
Serial port I/F	RS485*1, RS422*1, RS232*1, CAN*1, USB*1
RAM capacity	JOB 200,000 steps, 10,000 robot commands (200MB)
Driving unit	6-axis AC servo system. External axis can be added as an option.

Operating conditions	
Use temperature	0~45°C
Storage temperature	-20~60°C
Humidity	10~90% RH, no condensing
Vibrations	Below 0.5G
Altitude	Below 1000m. (Degrade if over 1000m, max 2000m)
Other requirements	<ul style="list-style-type: none"> • With no corrosive or combustible gas • With no water, oil or drug splashing • With no electromagnetic field nearby • With no radiations nearby

► Working envelope (unit: mm)

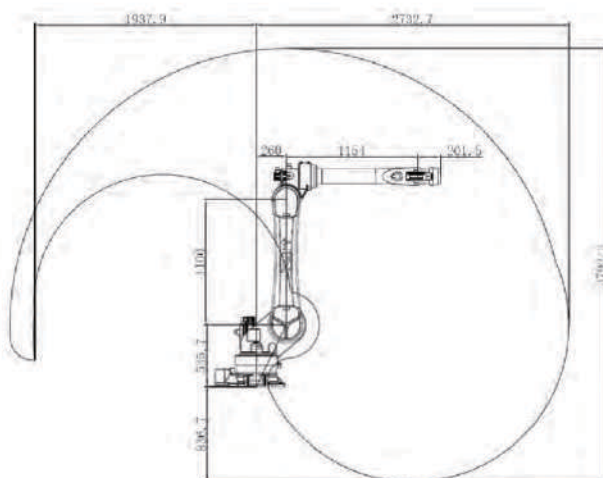

► Flange and base dimensions (unit: mm)

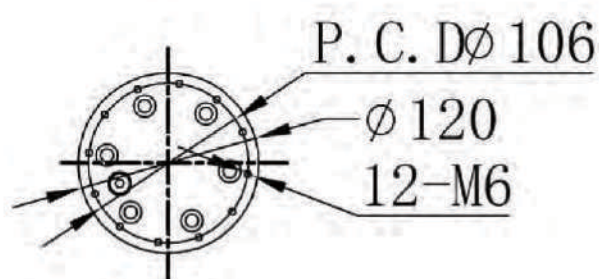

Flange

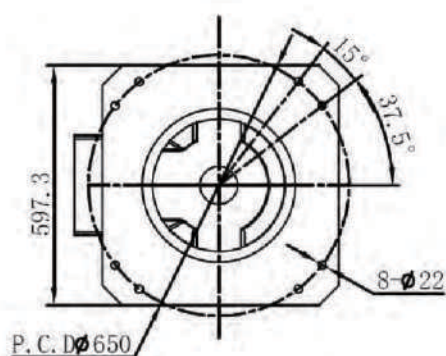

Base

All data, drawings and specifications provided in this catalog are purely for information purposes and do not constitute a guarantee of these characteristics. The extent of goods delivered and services performed is determined by the subject matter of the specific contract. No liability accepted for errors or omissions.

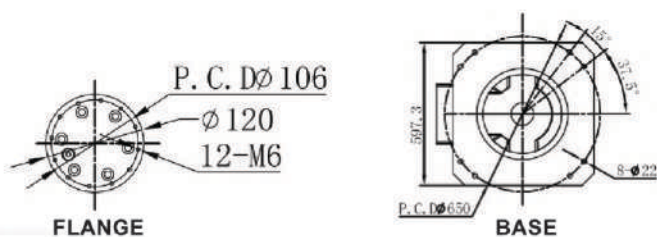
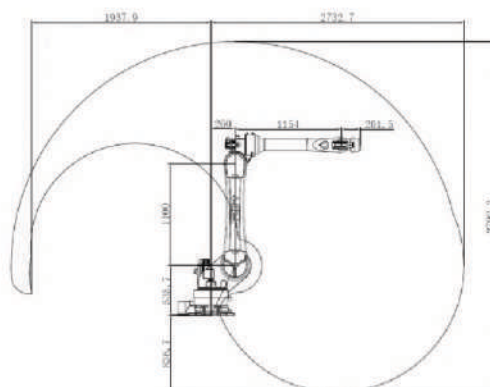

Robot specifications

Basic parameters	
Model No.	YSRT100A-270
Controlled axis	6-DOF
Max payload	100 kg
Max stroke	2732 mm
IP Level	J1, J2-IP56; J3, J4, J5, J6-IP67
Installation mode	Floor type, ceiling type
Robot mass	680 kg
Repeatability	±0.15 mm
Applications	<ul style="list-style-type: none"> ● Pick-n-place / Palletizing ● Spraying / Packaging / Cutting
Travel range	
J1 axis S	±165°
J2 axis L	+80°~-90°
J3 axis U	+105°~-75°
J4 axis R	±180°
J5 axis B	+98°~-90°
J6 axis T	±360°
Travel speed	
J1 axis S	127 °/s
J2 axis L	70 °/s
J3 axis U	74.5 °/s
J4 axis R	137 °/s
J5 axis B	99 °/s
J6 axis T	222 °/s

Installation environment

Ambient temperature	0~45°C
Humidity	20~80%RH, no condensing
Vibrations	Below 0.5G
Altitude	Below 1000m
Other requirements	<ul style="list-style-type: none"> ● With no corrosive or combustible gas ● With no water, oil or drug splashing ● With no electromagnetic field nearby ● With no radiations nearby



6-AXIS HANDLING ROBOT

YSRT100-270

Special long-stroke design.
Suitable for pick-n-place and palletizing.

Robot specifications

Basic data	
Model No.	YSRT100-270
Number of axes	6
Maximum payload	50 kg
Maximum stroke	1700mm
IP class	J1, J2 - IP56; J3, J4, J5, J6- IP67
Mounting position	Floor type
Approx. weight	615 kg (without cabinet)
Repeatability	±0.15 mm
Internal air duct	Φ10
Motion range	
J1 axis S	±165°
J2 axis L	+80°~-90°
J3 axis U	+105°~-75°
J4 axis R	±180°
J5 axis B	+98°~-90°
J6 axis T	±360°
Speed with rated payload	
J1 axis S	127°/s
J2 axis L	70°/s
J3 axis U	74.5°/s
J4 axis R	137°/s
J5 axis B	99°/s
J6 axis T	222°/s

Electrical cabinet specifications	
Dimensions	560*500*730mm
Approx. weight	80KG
Cooling method	Natural cooling
Input power	380VAC 50/60Hz
Grounding	Industrial grounding (grounding resistance below 100Ω)
I/O terminals	<ul style="list-style-type: none"> • 16 digital inputs • 16 digital outputs • 2 analog outputs (optional)
Position control mode	EtherCAT, TCP/IP
Serial port I/F	RS485*1, RS422*1, RS232*1, CAN*1, USB*1
RAM capacity	JOB 200,000 steps, 10,000 robot commands (200MB)
Driving unit	6-axis AC servo system. External axis can be added as an option.

Operating conditions	
Use temperature	0~45°C
Storage temperature	-20~60°C
Humidity	10~90% RH, no condensing
Vibrations	Below 0.5G
Altitude	Below 1000m. (Degrade if over 1000m, max 2000m)
Other requirements	<ul style="list-style-type: none"> • With no corrosive or combustible gas • With no water, oil or drug splashing • With no electromagnetic field nearby • With no radiations nearby

► Working envelope (unit: mm)

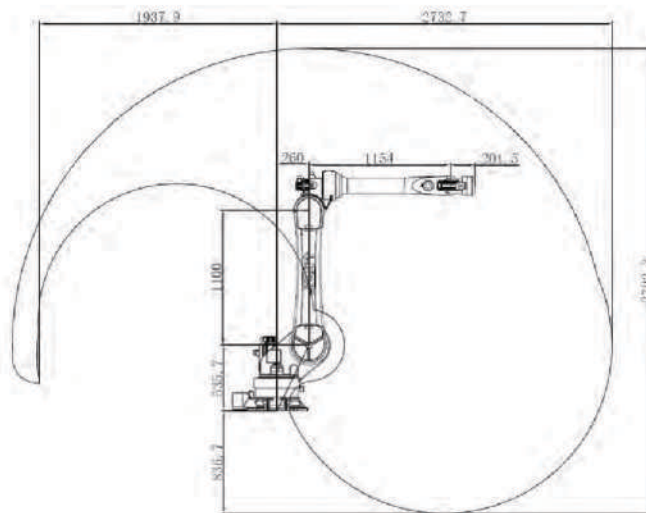

► Flange and base dimensions (unit: mm)

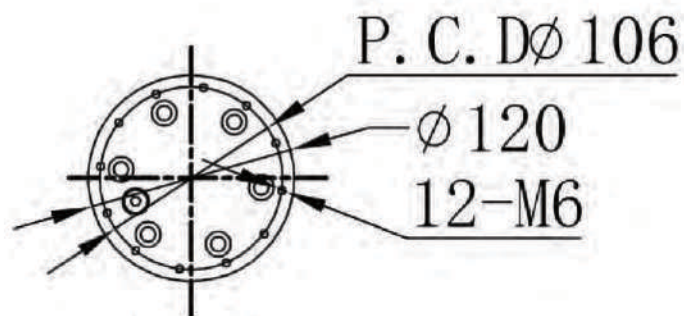

Flange

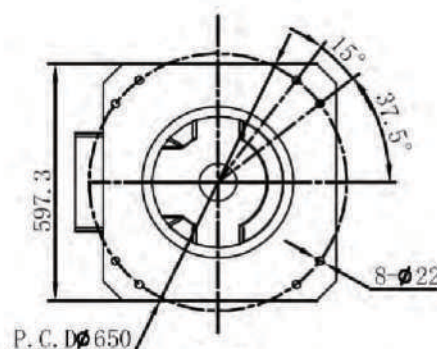

Base

All data, drawings and specifications provided in this catalog are purely for information purposes and do not constitute a guarantee of these characteristics. The extent of goods delivered and services performed is determined by the subject matter of the specific contract. No liability accepted for errors or omissions.

6-AXIS HANDLING ROBOT

YS-F120R2230

Heavy duty, fast and accurate.
Suitable for pick-n-place, machine tending, palletizing, polishing, glue dispensing and painting.



Robot specifications

Basic data	
Model No.	YS-F120R2230
Number of axes	6
Maximum payload	120 kg
Maximum stroke	2230mm
IP class	J1, J2 - IP56; J3, J4, J5, J6- IP67
Mounting position	Floor type
Approx. weight	700 kg (without cabinet)
Repeatability	±0.06 mm
Internal air duct	Φ10
Motion range	
J1 axis S	±185°
J2 axis L	+154°~-65°
J3 axis U	+170°~-80°
J4 axis R	±360°
J5 axis B	±120°
J6 axis T	±360°
Speed with rated payload	
J1 axis S	130°/s
J2 axis L	110°/s
J3 axis U	120°/s
J4 axis R	170°/s
J5 axis B	170°/s
J6 axis T	250°/s

Electrical cabinet specifications	
Dimensions	560*500*800mm
Approx. weight	80KG
Cooling method	Natural cooling
Input power	380VAC 50/60Hz
Grounding	Industrial grounding (grounding resistance below 100Ω)
I/O terminals	<ul style="list-style-type: none"> • 16 digital inputs • 16 digital outputs • 2 analog outputs (optional)
Position control mode	EtherCAT, TCP/IP
Serial port I/F	RS485*1, RS422*1, RS232*1, CAN*1, USB*1
RAM capacity	JOB 200,000 steps, 10,000 robot commands (200MB)
Driving unit	6-axis AC servo system. External axis can be added as an option.

Operating conditions	
Use temperature	0~45°C
Storage temperature	-20~60°C
Humidity	10~90% RH, no condensing
Vibrations	Below 0.5G
Altitude	Below 1000m. (Degrade if over 1000m, max 2000m)
Other requirements	<ul style="list-style-type: none"> • With no corrosive or combustible gas • With no water, oil or drug splashing • With no electromagnetic field nearby • With no radiations nearby



Model No.	YS-F210R2700A
Controlled axis	6 axis
Max payload	210KG
Max stroke	2700mm
Repeatability	±0.1 mm
Wrist IP Level	IP65
Installation mode	Floor type
Vibration level	Below 0.5G
Ambient temperature	0~45°C, 20~85%RH (no condensing)
Robot mass	1131KG
Travel range	
J1 axis S	±185°
J2 axis L	-50°~+85°
J3 axis U	-155°~+120°
J4 axis R	±350°
J5 axis B	±125°
J6 axis T	±350°
Travel speed	
J1 axis S	123°/s
J2 axis L	115 °/s
J3 axis U	120 °/s
J4 axis R	179 °/s
J5 axis B	172°/s
J6 axis T	219 °/s



6-AXIS HANDLING ROBOT

YS-F210R2700

Top class heavy duty. Powerful, fast and accurate.
Suitable for pick-n-place, machine tending, palletizing, polishing, glue dispensing and painting.

Robot specifications

Basic data	
Model No.	YS-F210R2700
Number of axes	6
Maximum payload	210 kg
Maximum stroke	2700mm
IP class	J1, J2 - IP56; J3, J4, J5, J6- IP67
Mounting position	Floor type
Approx. weight	1130 kg (without cabinet)
Repeatability	±0.06 mm
Internal air duct	Φ10
Motion range	
J1 axis S	±185°
J2 axis L	+85°~-50°
J3 axis U	+210°~-65°
J4 axis R	±350°
J5 axis B	±125°
J6 axis T	±350°
Speed with rated payload	
J1 axis S	123°/s
J2 axis L	115°/s
J3 axis U	112°/s
J4 axis R	179°/s
J5 axis B	172°/s
J6 axis T	219°/s

Electrical cabinet specifications	
Dimensions	560*500*800mm
Approx. weight	100KG
Cooling method	Natural cooling
Input power	380VAC 50/60Hz
Grounding	Industrial grounding (grounding resistance below 100Ω)
I/O terminals	<ul style="list-style-type: none"> • 16 digital inputs • 16 digital outputs • 2 analog outputs (optional)
Position control mode	EtherCAT, TCP/IP
Serial port I/F	RS485*1, RS422*1, RS232*1, CAN*1, USB*1
RAM capacity	JOB 200,000 steps, 10,000 robot commands (200MB)
Driving unit	6-axis AC servo system. External axis can be added as an option.

Operating conditions	
Use temperature	0~45°C
Storage temperature	-20~60°C
Humidity	10~90% RH, no condensing
Vibrations	Below 0.5G
Altitude	Below 1000m. (Degrade if over 1000m, max 2000m)
Other requirements	<ul style="list-style-type: none"> • With no corrosive or combustible gas • With no water, oil or drug splashing • With no electromagnetic field nearby • With no radiations nearby

► Working envelope (unit: mm)

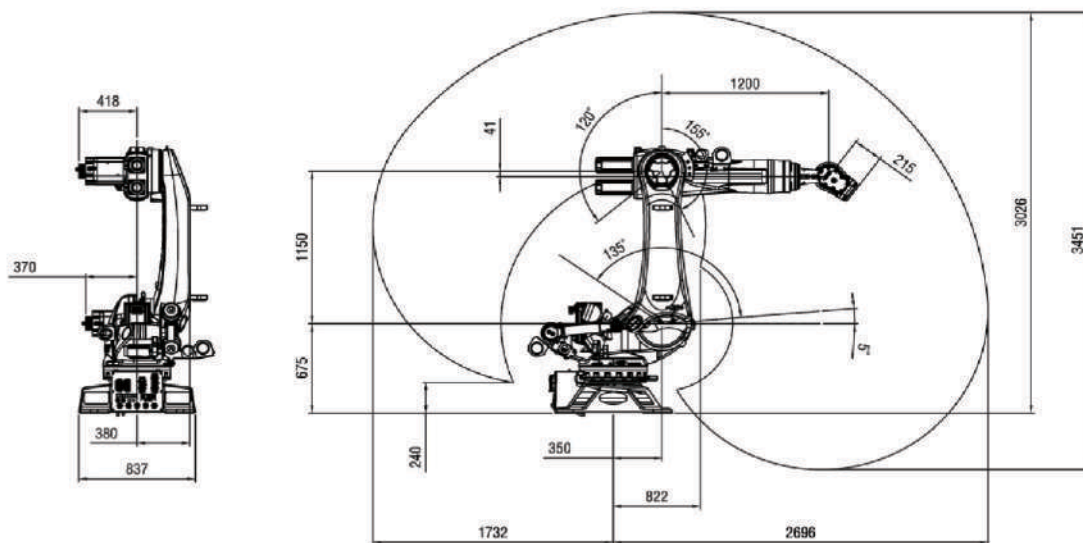

► Flange and base dimensions (unit: mm)

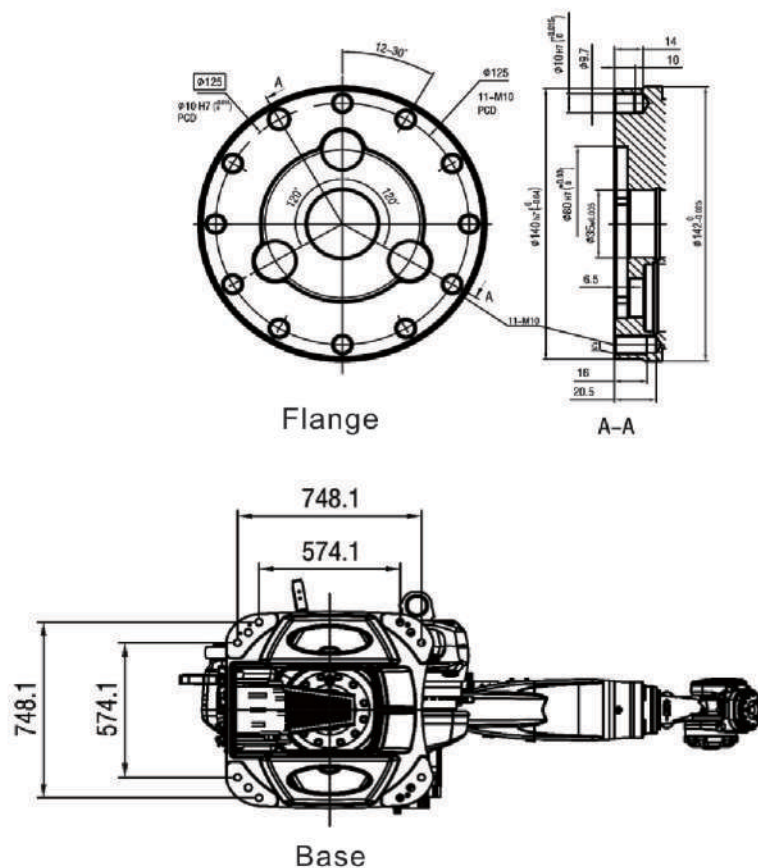

All data, drawings and specifications provided in this catalog are purely for information purposes and do not constitute a guarantee of these characteristics. The extent of goods delivered and services performed is determined by the subject matter of the specific contract. No liability accepted for errors or omissions.



SCARA ROBOT

YS06-502S/602S/702S

Fast, accurate and reliable.

Suitable for pick-n-place of 3C industry.

Robot specifications

Basic data	
Model No.	YS06-502S/602S/702S
Number of axes	4
Maximum payload	6 kg
Maximum stroke	500/600/700mm
IP class	J1, J2 - IP56; J3, J4- IP67
Mounting position	Floor type
Approx. weight	30 kg (without cabinet)
Repeatability	±0.02 mm
Internal air duct	Φ6
Motion range	
J1 axis S	±132°
J2 axis L	±150°
J3 axis U	220mm
J4 axis R	±360°
Speed with rated payload	
J1 axis S	540°/s
J2 axis L	600°/s
J3 axis U	750°/s
J4 axis R	1717°/s

Electrical cabinet specifications	
Dimensions	490*400*365mm
Approx. weight	40KG
Cooling method	Natural cooling
Input power	220VAC 50/60Hz
Grounding	Industrial grounding (grounding resistance below 100Ω)
I/O terminals	<ul style="list-style-type: none"> • 16 digital inputs • 16 digital outputs • 2 analog outputs (optional)
Position control mode	EtherCAT, TCP/IP
Serial port I/F	RS485*1, RS422*1, RS232*1, CAN*1, USB*1
RAM capacity	JOB 200,000 steps, 10,000 robot commands (200MB)
Driving unit	6-axis AC servo system. External axis can be added as an option.

Operating conditions	
Use temperature	0~45°C
Storage temperature	-20~60°C
Humidity	10~90% RH, no condensing
Vibrations	Below 0.5G
Altitude	Below 1000m. (Degrade if over 1000m, max 2000m)
Other requirements	<ul style="list-style-type: none"> • With no corrosive or combustible gas • With no water, oil or drug splashing • With no electromagnetic field nearby • With no radiations nearby

► Working envelope (unit: mm)

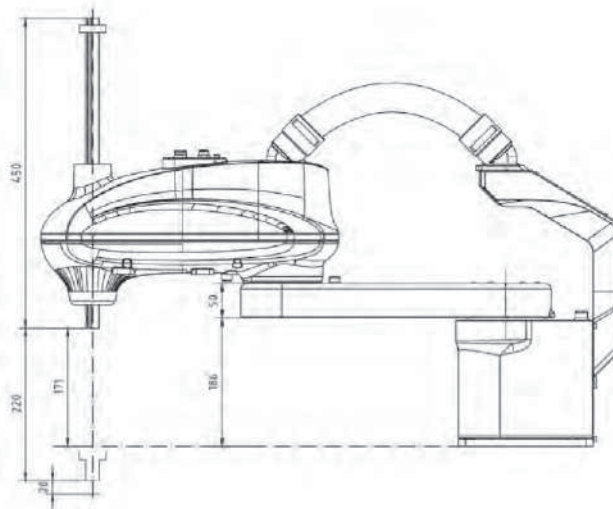

► Flange and base dimensions (unit: mm)

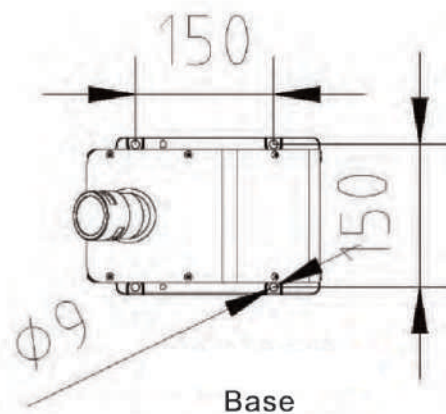

► Payload diagram

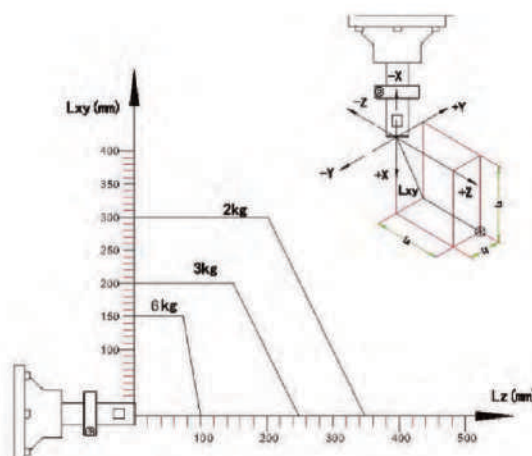

All data, drawings and specifications provided in this catalog are purely for information purposes and do not constitute a guarantee of these characteristics. The extent of goods delivered and services performed is determined by the subject matter of the specific contract. No liability accepted for errors or omissions.



6-AXIS HANDLING ROBOT

YS30-1840

Fast, accurate and reliable.

Suitable for pick-n-place, machine tending, palletizing and painting.

Robot specifications

Basic data	
Model No.	YS30-1800
Number of axes	6
Maximum payload	30 kg
Maximum stroke	1840mm
IP class	J1, J2 - IP56; J3, J4, J5, J6- IP67
Mounting position	Floor type, wall type, ceiling type
Approx. weight	260 kg (without cabinet)
Repeatability	±0.08 mm
Internal air duct	Φ10
Motion range	
J1 axis S	□167°
J2 axis L	+92°~-150°
J3 axis U	+110°~-85°
J4 axis R	±150°
J5 axis B	+20°~-200°
J6 axis T	±360°
Speed with rated payload	
J1 axis S	200°/s
J2 axis L	198°/s
J3 axis U	163°/s
J4 axis R	296°/s
J5 axis B	333°/s
J6 axis T	333°/s

Electrical cabinet specifications	
Dimensions	650*495*580mm
Approx. weight	80KG
Cooling method	Natural cooling
Input power	380VAC 50/60Hz
Grounding	Industrial grounding (grounding resistance below 100Ω)
I/O terminals	<input type="checkbox"/> 16 digital inputs <input type="checkbox"/> 16 digital outputs <input type="checkbox"/> 2 analog outputs (optional)
Position control mode	EtherCAT, TCP/IP
Serial port I/F	RS485*1, RS422*1, RS232*1, CAN*1, USB*1
RAM capacity	JOB 200,000 steps, 10,000 robot commands (200MB)
Driving unit	6-axis AC servo system. External axis can be added as an option.

Operating conditions	
Use temperature	0~45°C
Storage temperature	-20~60°C
Humidity	10~90% RH, no condensing
Vibrations	Below 0.5G
Altitude	Below 1000m. (Degrade if over 1000m, max 2000m)
Other requirements	<input type="checkbox"/> With no corrosive or combustible gas <input type="checkbox"/> With no water, oil or drug splashing <input type="checkbox"/> With no electromagnetic field nearby <input type="checkbox"/> With no radiations nearby

► Working envelope (unit: mm)

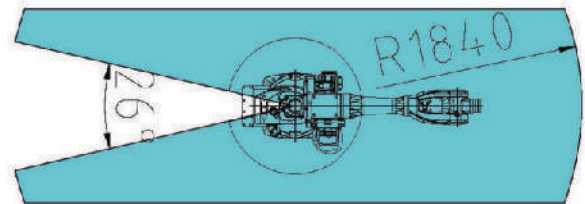
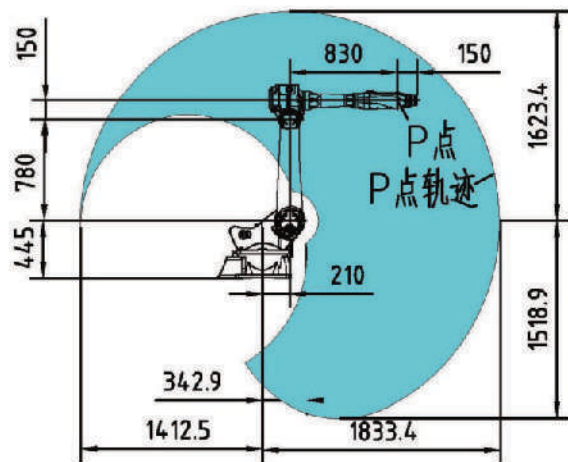

► Flange and base dimensions (unit: mm)

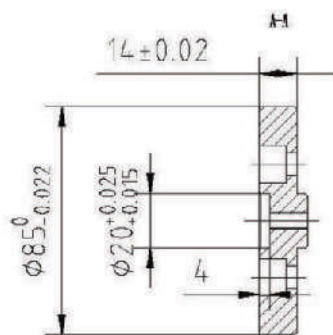

Flange

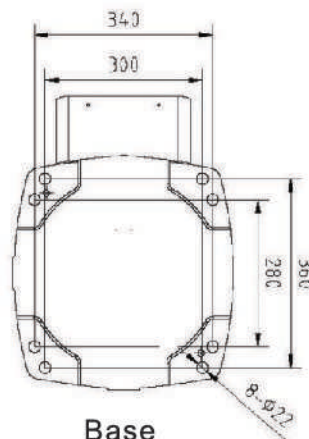
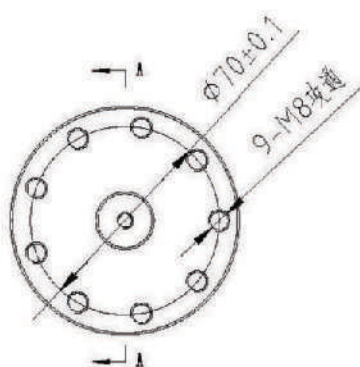

Base

► Payload diagram

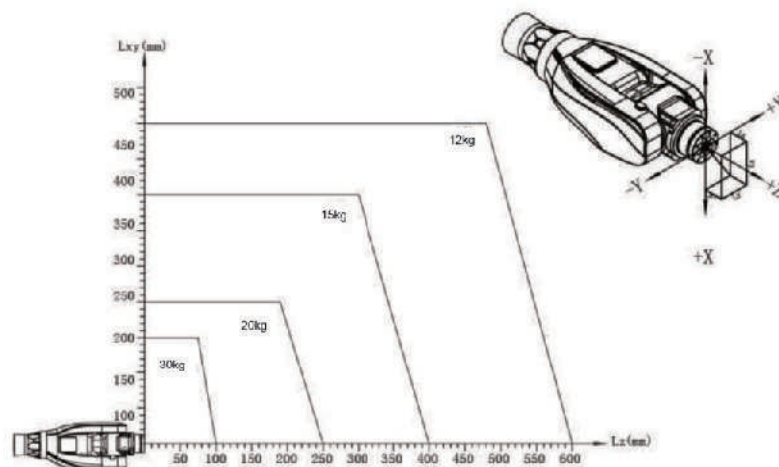

All data, drawings and specifications provided in this catalog are purely for information purposes and do not constitute a guarantee of these characteristics. The extent of goods delivered and services performed is determined by the subject matter of the specific contract. No liability accepted for errors or omissions.



6-AXIS HANDLING ROBOT

YS80-2250

Enclosed design. Heavy duty.

Suitable for pick-n-place, machine tending, palletizing, polishing and painting.

Robot specifications

Basic data	
Model No.	YS80-2250
Number of axes	6
Maximum payload	80 kg
Maximum stroke	2250mm
IP class	J1, J2 - IP56; J3, J4, J5, J6- IP67
Mounting position	Floor type, wall type, ceiling type
Approx. weight	560 kg (without cabinet)
Repeatability	±0.08 mm
Internal air duct	Φ8/10
Motion range	
J1 axis S	<input type="checkbox"/> 160°
J2 axis L	+90°~120°
J3 axis U	+140°~70°
J4 axis R	±190°
J5 axis B	+30°~210°
J6 axis T	±360°
Speed with rated payload	
J1 axis S	216°/s
J2 axis L	150 °/s
J3 axis U	175°/s
J4 axis R	378 °/s
J5 axis B	286 °/s
J6 axis T	370°/s

Electrical cabinet specifications	
Dimensions	850*550*920mm
Approx. weight	95KG
Cooling method	Natural cooling
Input power	380VAC 50/60Hz
Grounding	Industrial grounding (grounding resistance below 100Ω)
I/O terminals	<input type="checkbox"/> 16 digital inputs <input type="checkbox"/> 16 digital outputs <input type="checkbox"/> 2 analog outputs (optional)
Position control mode	EtherCAT, TCP/IP
Serial port I/F	RS485*1, RS422*1, RS232*1, CAN*1, USB*1
RAM capacity	JOB 200,000 steps, 10,000 robot commands (200MB)
Driving unit	6-axis AC servo system. External axis can be added as an option.

Operating conditions	
Use temperature	0~45°C
Storage temperature	-20~60°C
Humidity	10~90% RH, no condensing
Vibrations	Below 0.5G
Altitude	Below 1000m. (Degrade if over 1000m, max 2000m)
Other requirements	<input type="checkbox"/> With no corrosive or combustible gas <input type="checkbox"/> With no water, oil or drug splashing <input type="checkbox"/> With no electromagnetic field nearby <input type="checkbox"/> With no radiations nearby

► Working envelope (unit: mm)

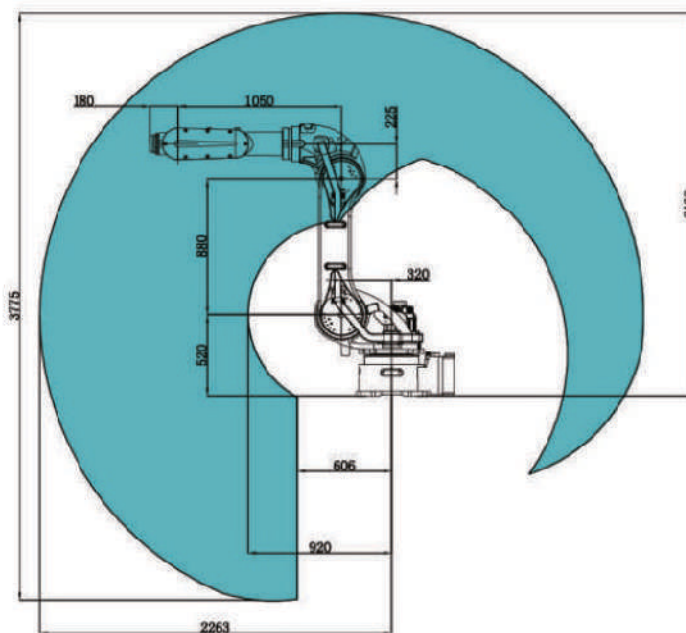

► Flange and base dimensions (unit: mm)

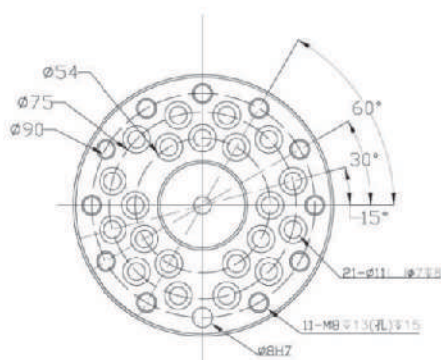

Flange

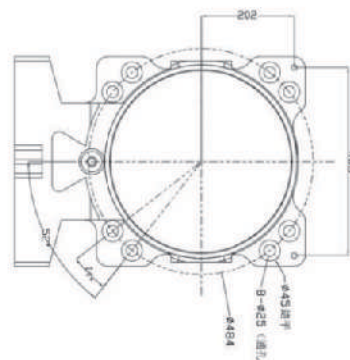

Base

► Payload diagram

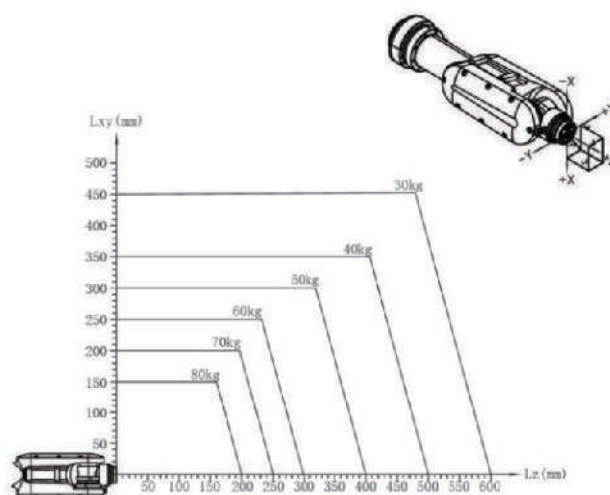

All data, drawings and specifications provided in this catalog are purely for information purposes and do not constitute a guarantee of these characteristics. The extent of goods delivered and services performed is determined by the subject matter of the specific contract. No liability accepted for errors or omissions.

Single-axis head-n-tail stock

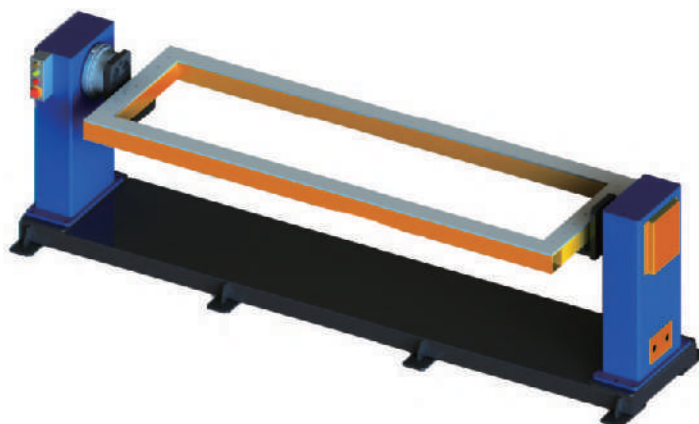

Specifications

Model	YRP-D1-250A	YRP-D1-500A	YRP-D1-1000A	YRP-D1-2-250A	YRP-D1-2-500A	YRP-D1-2-1000A
Payload (kg)	250	500	1000	250	500	1000
Height(mm)	700					
Gravity center(mm)	≤300					
Frame (mm)	1800*800			2500*800		
Rotation speed(°/s)	60		40	60		40
Rotation angle(°)	±180					
Eccentricity (mm)	≤150		≤100	≤150		≤100
Repeatability(arcmin)	±1.0		±1.2	±1.0		±1.2
RV gearbox ratio	40E-121	80E-153	160E-172	40E-121	80E-153	160E-172
Servo motor(kw)	1.5		3.0	1.5		3.0

Single-axis rotational table



Specifications

Model	YRP-D3-200A	YRP-D3-500A	YRP-D3-1000A
Payload (kg)	200	500	1000
Gravity center(mm)	≤200	≤250	≤300
Disk diameter(mm)	350	500	800
Rotation speed(°/s)	60		40
Rotation angle(°)	± 360		
Eccentricity (mm)	≤200	≤250	≤300
Repeatability(arcmin)	±1.0		
RV gearbox ratio	40E-105	40E-105	80E-153
Servo motor(kw)	1	1.5	2

Single-axis linear unit



Specifications

Model	YRP - DZX1-3000-500A	YRP - DZX1-4000-500A
Payload (kg)	500	
Effective stroke (mm)	2300	3300
Trail length (mm)	3000	4000
Max speed (m/min)	15	
Repeatability (mm)	±0.05	
Gearbox ratio	PLF120-25	
Servomotor (kw)	1.5	

Two-axis P-type positioner

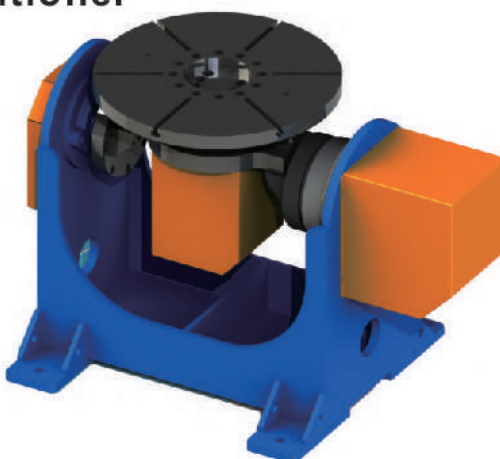

Specifications

Model	YRP -S1-200A	YRP -S1-300A	YRP -S1-500A
Payload (kg)	200	300	500
Gravity center (mm)	≤120		≤100
Disk diameter (mm)	400	500	600
Rotation speed (°/s) -J7/J8	80/80	60/80	50/50
Rotation angle (°) -J7/J8	±90/±360		
Eccentricity (mm)	≤120		≤100
Repeatability (arcmin)	±1.0		±1.5
RV gearbox ratio -J7/J8	40E-105/80E-153	40E-105/110E-161	80E-153/110E-161
Servomotor (kw) -J7/J8	1.5/1.0	1.5/1.5	2.0/1.5

Two-axis L-type positioner



Specifications

Model	YRP-SL1-500A	YRP-SL1-1000A	YRP-SL1-2000A
Payload (kg)	500	1000	2000
Gravity center (mm)	≤500	≤400	≤300
Disk diameter (mm)	400	500	600
Rotation speed (°/s) -J7/J8	50/70		20/20
Rotation angle (°) -J7/J8	±175/±360		
Eccentricity (mm)	≤250	≤200	≤150
Repeatability (arcmin)	±1.5		
RV gearbox ratio -J7/J8	40E-105/80E-153	80E-153/110E-161	110E-161/160E-172
Servo motor (kw) -J7/J8	1.5/1.0	2.0/1.5	3.0/2.0

Two-axis C-type positioner



Specifications

Model	YRP-SC3-200A	YRP-SC3-300A	YRP-SC3-500A
Payload (kg)	200	300	500
Gravity center (mm)	≤200		
Disk diameter (mm)	450	650	
Rotation speed (°/s) -J7/J8	60/75		20/75
Rotation angle (°) -J7/J8	±90/±360		
Eccentricity (mm)	≤100		
Repeatability (arcmin)	±1.0	±1.5	
RV gearbox ratio -J7/J8	40E-105/110E-161		110E-161/160E-172
Servo motor (kw) -J7/J8	2.0/1.0	3.0/1.5	3.0/2.0

Three-axis horizontal positioner

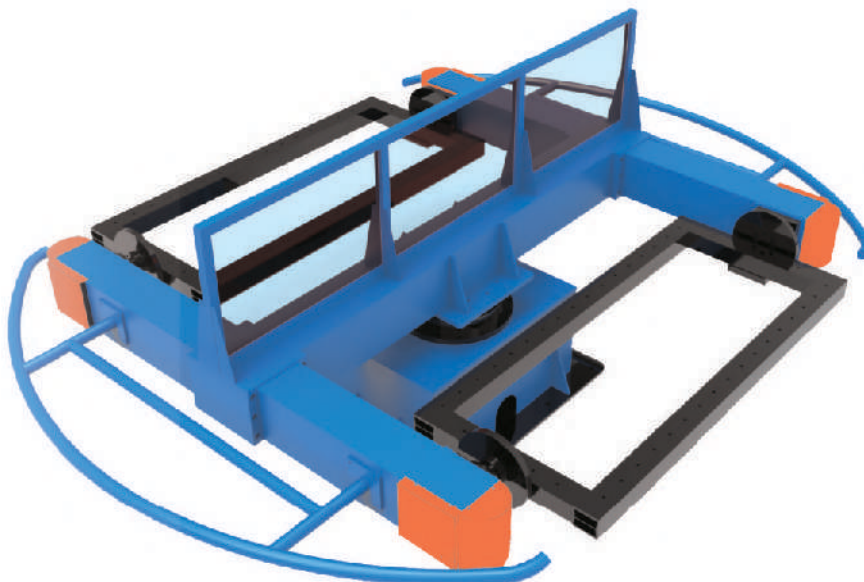

Specifications

Model	YRP - SP1- 500A	YRP - SP1- 1000A
Payload (kg)	500	1000
Gravity center (mm)	≤300	
Turning radius (mm)	650	
Rotation speed (°/s) -J7/J8/J9	30/60/60	
Rotation angle(°) -J7/J8/J9	±180/±360/±360	
Repeatability (arcmin)	±1.5	
Gearbox ratio	110E-161/110E-161/40E-105	160E-172/110E-161/110E-161
Servo motor (kw)	1.5/1.5/1.5	3.0/3.0/3.0

Welding machines



Selection table

Base metal	Thickness (mm)	Technique	Wire diameter(mm)	Weld current (A)	Applicable model
Carbonsteel	0.8~4.0	CO ₂ /MAG	0.8, 1.0, 1.2	60~200	NBC-350R/NBC-350RL
Carbonsteel	≥4.0	CO ₂ /MAG	1.0, 1.2, 1.6	150~450	NBC-500R/MIG-500RP
Stainless steel	0.8~3.0	CO ₂ /MAG	0.8, 1.0, 1.2	60~150	NBC-350RL
Stainless steel	2.0~10.0	MIG	1.0, 1.2	80~280	MIG-350RP
Stainless steel	≥4.0	MIG	1.2, 1.6	150~400	MIG-500RP
Aluminum(alloy)	1.5~10.0	MIG	1.2, 1.6	60~280	MIG-350RP
Aluminum(alloy)	≥3.0	MIG	1.2, 1.6	120~400	MIG-500RP
Copper (alloy)	2.0~10.0	MIG	1.2	120~300	MIG-350RP
Copper (alloy)	≥6.0	MIG	1.2, 1.6	140~450	MIG-500RP

Optional parts

		
Wire feeder	Wire feeder	Anti-collision
		
Air-cooling torch	Water-cooling torch	Water tank
		
Communication board	Wire holder	Wire duct

Standard model: NBC-350R/500R



Features

- Suitable for CO₂/MAG/MIG welding of various kinds of carbon steel & galvanized sheet;
- Full digital system to achieve precise control of droplet transfer and stable welding quality;
- Soft switch inverting technology to achieve reliability and energy saving;
- Digital wire feeding system for reliable feeding despite power source fluctuations or wire feeding obstructions;
- Equipped with synergy/separate adjustment modes for easy configurations;
- Full protections: overcurrent, overvoltage, undervoltage, overheat, power-on self-protection etc.;
- Adjustable arc ignition & extinguish parameters;
- Up to 100 groups of customizable parameters.

Specifications

Model	NBC-350R	NBC-500R
Rated input power	3PH 380VAC, 50/60Hz	
Rated input capacity (KVA)	14	25
Rated input current(A)	21	38
Rated output voltage (V)	31.5	39
Rated duty cycle (%)	60	100
OCV (V)	72	73
Output current range (A)	25~350	25~500
Output voltage range (V)	10~50	
Trigger mode	2/4T, Spot, Repeat	
Wire size (mm)	0.8, 1.0, 1.2	1.0, 1.2, 1.6
Gas flowrate (L/min)	15~20	
Protection class	IP23	
Insulation class	H	
External dimensions(mm)	660*320*560	
Mass	50	55

Low spatter model: NBC-350RL



Features

- Suitable for low spatter welding of 0.8 to 3mm carbon steel, stainless steel and galvanized sheet;
- Welding spatter reduced by up to 80% & heat input reduced by up to 20%, less deformation;
- High speed DSP+FPGA multi-core system for precise control of droplet transfer and stable welding quality;
- Soft switch inverting technology to achieve reliability and energy saving;
- Digital wire feeding system for reliable feeding despite power source fluctuations or wire feeding obstructions;
- Equipped with synergy/separate adjustment modes for easy configurations;
- Full protections: overcurrent, overvoltage, undervoltage, overheat, power-on self-protection etc.;
- Adjustable arc ignition & extinguish parameters;
- Up to 100 groups of customizable parameters.

Specifications

Model	NBC-350RL
Rated input power	3PH 380VAC, 50/60Hz
Rated input capacity(KVA)	14
Rated input current (A)	21
Rated output voltage (V)	31.5
Rated duty cycle (%)	60
OCV (V)	79
Output current range (A)	60~420
Output voltage range (V)	17~35
Trigger mode	2/4T, Spot, Repeat
Wire size (mm)	0.8, 1.0, 1.2
Gas flow rate (L/min)	15~20
Protection class	IP23
Insulation class	H
External dimensions (mm)	660*320*560
Mass	55

Pulse welding model: MIG-350RP/500RP



Features

- Suitable for CO₂/MAG/MIG welding of various kinds of carbon steel, stainless steel, aluminum & copper alloy;
- With enhanced dual pulse function to achieve perfect fish scale welding seam for aluminum alloys;
- Full digital system to achieve precise control of droplet transfer and stable welding quality;
- Soft switch inverting technology to achieve reliability and energy saving;
- Digital wire feeding system for reliable feeding despite power source fluctuations or wire feeding obstructions;
- Equipped with synergy/separate adjustment modes for easy configurations;
- Full protections: overcurrent, overvoltage, undervoltage, overheat, power-on self-protection etc.;
- Adjustable arc ignition & extinguish parameters;
- Up to 100 groups of customizable parameters.

Specifications

Model	MIG-350RP	MIG-500RP
Rated input power	3PH 380VAC, 50/60Hz	
Rated input capacity (KVA)	14	24
Rated input current (A)	21	36
Rated output voltage (V)	31.5	39
Rated duty cycle (%)	60	100
OCV (V)	72	73
Output current range (A)	25~350	25~500
Output voltage range (V)	10~50	
Trigger mode	2/4T, Spot, Repeat	
Wire size (mm)	0.8, 1.0, 1.2	1.0, 1.2, 1.6
Gas flowrate (L/min)	15~20	
Protection class	IP23	
Insulation class	H	
External dimensions (mm)	660*320*560	
Mass	50	55

Reliability: designed for tough working conditions

1. Designed against lightning and power surge. Class-D (6000V/3000A) Lightning Protection. Power source is ensured to work properly even in extreme weather, high voltage fluctuation and with power generators. When the input power is within +/- 25% of 3PH 380V (280V~475V) and 30~80HZ, the power sources will work normally.
2. 72 hours' temperature change test from -39°C to +50°C at 95% humidity and on-load condition.
3. Passing water spray test and reaching IP23S. Working reliably under raining situations.
4. Constant monitoring on the output connector's temperature. Alarming through digital meter to prevent damages caused by connector overheat.
5. Passing salt spray test, metal dust test and suspended conductive dust test.
6. Passing EMC test to ensure welding power source not to interfere with other equipment nearby, or to be interfered.
7. HALT, Highly Accelerated Life Test. Overlay test of various extreme conditions.

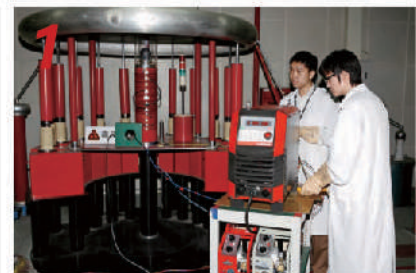

Consistency: same performance by any machine



Test machines by 5V as the standards								
Machine No.	1	2	3	4	5	6	7	8
load (current : A)	173.28	172.08	168.84	172.16	173.92	173.12	172.88	171.04
Output voltage(V)	5	4.97	4.91	4.97	5.01	5	5	4.94
Output voltage deviation	0	-0.03	-0.09	-0.03	0.01	0	0	-0.06
Display voltage deviation	0	0.070586	0.010586	0.070586	0.110586	0.100586	0.100586	0.040586
Test machines by 20V as the standards								
Machine No.	1	2	3	4	5	6	7	8
load (current : A)	197.2	196.96	198	196.72	196.96	196.64	197.12	196.88
Output voltage(V)	20.06	20.03	20.15	20.01	20.02	19.97	20.04	20.02
Output voltage deviation	0.06	0.03	0.15	0.01	0.02	-0.05	0.04	0.02
Display voltage deviation	0.06	0.03	0.15	0.01	0.02	-0.05	0.04	0.02
Test machines by 30V as the standards								
Machine No.	1	2	3	4	5	6	7	8
load (current : A)	295.44	295.12	295.28	294.88	295.44	295.2	295.28	295.12
Output voltage(V)	30.09	30.06	30.07	30.02	30.08	30.03	30.06	30.05
Output voltage deviation	0.09	0.06	0.07	0.02	0.08	0.03	0.06	0.05
Display voltage deviation	0.09	0.06	0.07	0.02	0.08	0.03	0.06	0.05
Test machines by 40V as the standards								
Machine No.	1	2	3	4	5	6	7	8
load (current : A)	545.36	544.8	541.28	544.24	545.6	544.8	544.88	546.24
Output voltage(V)	45.08	45.06	44.77	44.98	45.09	45.02	45.05	45.12
Output voltage deviation	0.08	0.06	-0.23	-0.02	0.09	0.02	0.05	0.12
Display voltage deviation	0.08	0.06	-0.23	0.080586	0.09	0.120586	0.05	0.12

■ Thanks to the design of high-frequency inverter and the excellent full digital-control, the dependency on the accuracy of hardware parameters are largely lowered. Consistent performance of each welding power source is therefore ensured even under input power network with large fluctuation.

■ By using components of low temperature drift and high accuracy, the output performance are kept consistent from turning-on to long-time operation, and from -39°C to +50°C working temperature.

■ Multiple compensation and automatic adjustment are designed for components in the sampling and control section.

Stability: smooth performance under changable conditions

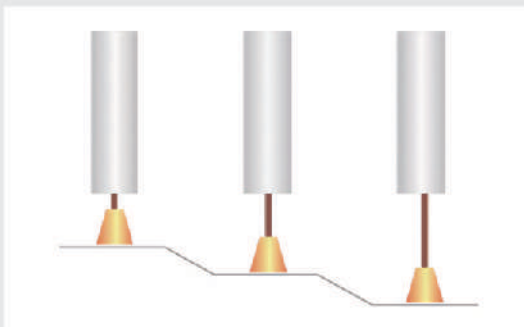
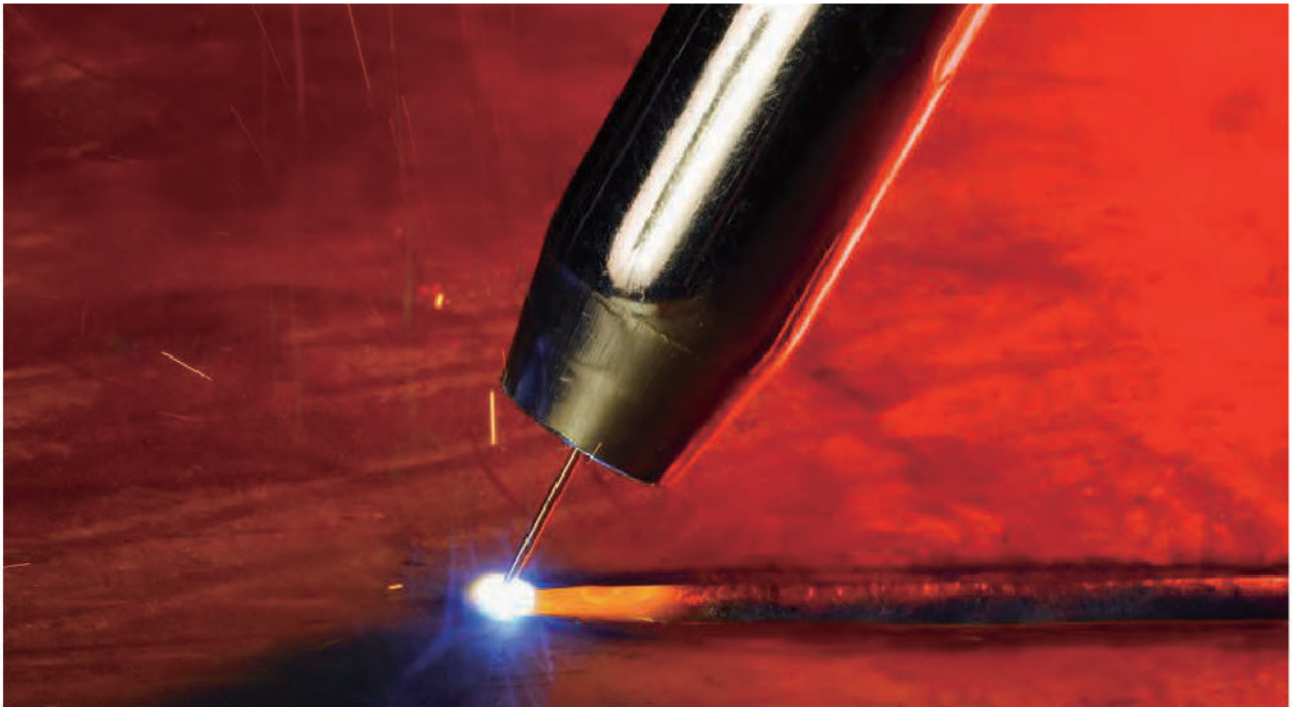

- The digital-control system enables the power sources to correct the transfer status of each metal droplet. Welding arc can be maintained stable while spatter is well controlled.
- The stick-out length is changeable when the welding arc reaches a different position. By adopting the unique technology of compensation on microcosmic welding voltage and of constant arc-length control, MEGMEET power source can ensure the stability of molten pool and welding arc, and to reach a constant depth of penetration.
- By adopting the technology of compensation on macroscopic welding voltage, MEGMEET power source is able to prevent arc voltage from decreasing when working with long connection cable.

Intelligence: to connect with Industry 4.0



- Deeply open for configuration to meet the professional challenges. For special welding applications in special situations, welding process can be tailor-made.
- With the CAN BUS connector as a standard, and more communication connectors as optional, MEGMEET welding systems are well prepared for seamless and digital connection with robot controller, automatic fixtures and group control systems.
- Synergic control and welding arc characteristics of wide adaptation are built on the basis of MEGMEET's welding data base of experts. Together, they have largely upgraded the feasibility and tolerance for automatic welding systems.
- The full digital-control system comes with one of the industry's best designs of anti-interference. The output specifications are able to be maintained stabilized, even under conditions of extreme temperature, moisture, grid fluctuation, power surge, conduction and radiation of high frequency.
- Sampling and control at high accuracy, supporting high-quality and stabilized welding at different output current from 30A to 500A.
- Analog and digital connectors of different types are equipped for robotic welding. Welding specifications are able to be transmitted at real time to the robot controller. By working with its algorithm, seam tracking can be operated thru welding arc.
- The digital communication system works as fast as 500KHZ. Distortion and delay with intermediate equipment are prevented. Reaction of the whole system is largely increased.
- With the highly flexible configuration of communication, and the deeply open welding specification, the performance limit is extended to reach weling result of higher stability, higher speed and lower heat-input.



Cost-effectiveness: lower in total cost of ownership

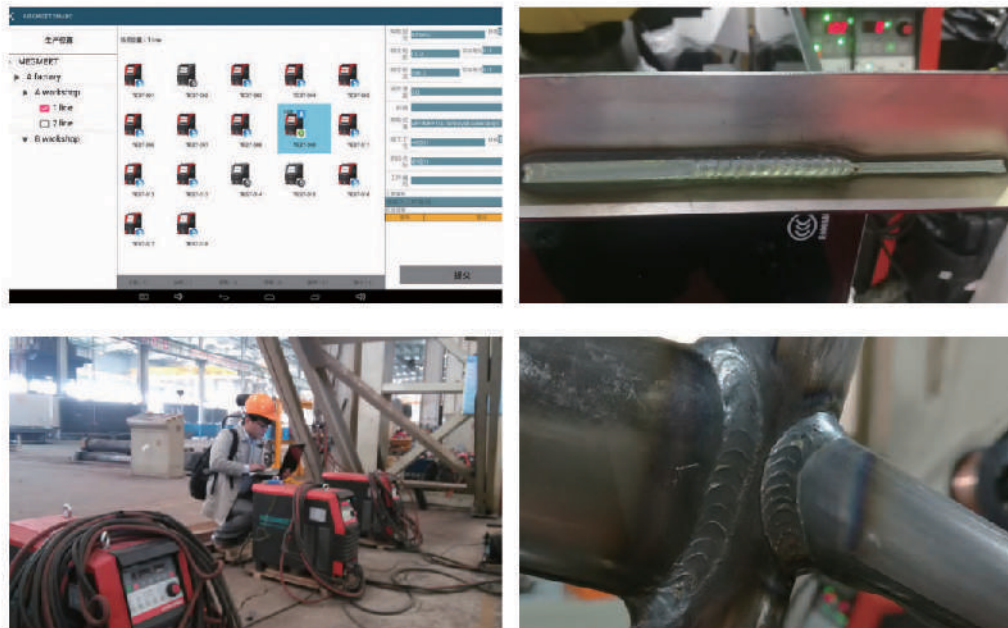

Lower Cost Means Hi Profit

- Saving with lower downtime. With the self-protecting design, power sources will display an error code on the meter. Once the errors are removed, the system will return to work as normal. Breakdowns and downtimes will be prevented.
- Saving with lower power consumption. Power consumption of 7 KWH is saved after welding every spool of MIG wire, compared with the thyristor (SCR) welding machines.
- Saving with ability to meet various thickness. For different output current, welding performance is maintained at a satisfactory level.
- Saving with software updating of welding procedure specification. Once a new welding process is requested, end-users may upgrade the welding application software instead of investing into a totally new welding system.
- Saving thru welding quality control. With the locking-up function, on-site QC managers are able to prevent any unnecessary change of welding specification by welders. Inspection cost will be largely saved.
- Saving thru group control system. SMARC, the group control system, is able to link welding power sources of a large number to MES. Management cost will be largely saved thru monitoring the welding specification, thru data collecting and analysing.

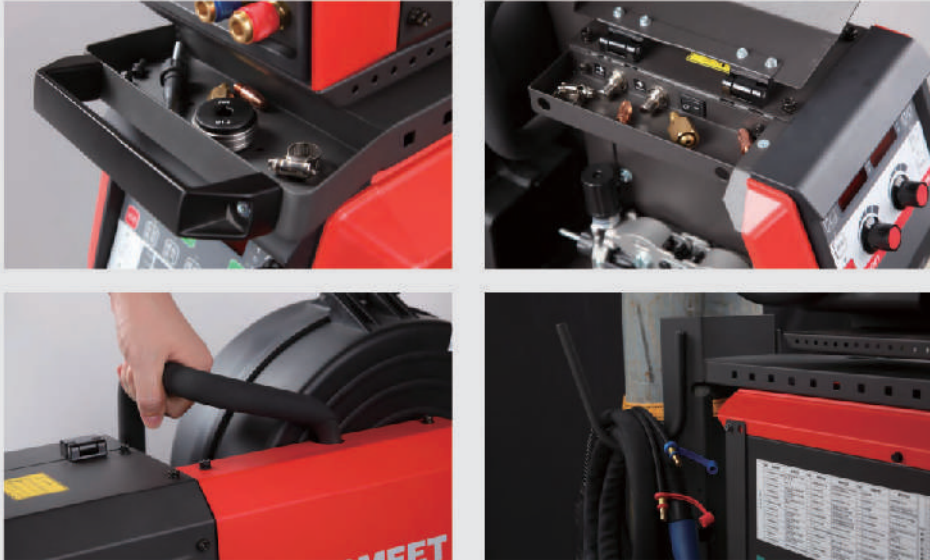

User-friendly Design: convenient to use

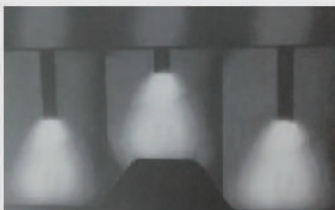

Easy-to-Use Design for Unskilled Welders

- Built-in Function of Anti-shake
- On/Off Option of Synergi Control
- On/Off Option of Constant Penetration



Locking-up Function

- Without any external device, a locking-up password is able to be set up on the front panel. The requested welding specifications will be strictly prevented from unnecessary change. Management and inspection cost will be lowered, while welding quality will be ensured.

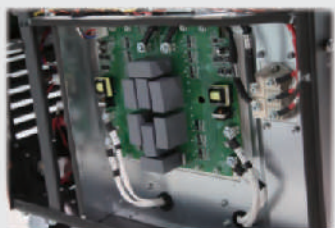

Quick Recovery of Production

- The embedded structure and the modular design increase the reliability. Dismantling and re-assembly will be short in time consumption.
- The power source is designed to detect abnormality in the whole system. An error code will be displayed, but the power source won't be damaged.

Welding Machine Model List

Model	Material				Process			Featured Process			Featured Functions				Torch Connector	Trolley	Water-cooler	Communication with Robot & Automation				SMARC Control
	Carbon Steel / Stainless Steel Wire	Aluminum Alloy	Silicon Bronze	Aluminum Bronze	CO ₂ MIG/ MAG	FCAW	Pulse MIG/ MAG	Tranquil Fusion	Thunder Leap Fusion	Clean QPT Fusion	Constant Penetration (3)	Intermediate Wire-feeder	Push-Pull Torch Module	Digital Meter Wire-feeder				Analog DeviceNet	CAN Open	MEGMEET CAN	EtherNet/IP	
Ehava CM 500H / 400 / 350 / 250	•				•	•		•						Panasonic	•	•				•		
Artsen CM 500C	•				•	•		•						Euro; Panasonic	•	•				•		
Artsen II CM 500 / 400 / 350	•				•	•		•			•	•		Euro; Panasonic (2)	•	•	•	•	•	•		
Artsen II PM 500 / 400 / 350 F	•		•	•	•	•		•			•	•		Euro; Panasonic (2)	•	•	•	•	•	•		
Artsen II PM 500 / 400 / 350 N	•	•	•	•	•	•		•			•	•		Euro; Panasonic (2)	•	•	•	•	•	•		
Artsen II PM 500 / 400 / 350 AS	•	•	•	•	•	•	• ⁽¹⁾	•			•	•		Euro; Panasonic (2)	•	•	•	•	•	•		
Artsen II PM 500 / 400 / 350 AD	•	•	•	•	•	•		•			•	•		Euro; Panasonic (2)	•	•	•	•	•	•		
Artsen Plus 500 / 400 D	•	•			•				•	•	•	•		Euro; Panasonic (2)	•	•	•	•	•			
Artsen Plus 500 / 400 P	•	•			•			•	•	•	•	•		Euro; Panasonic (2)	•	•	•	•	•	•		
Artsen Plus 500 / 400 Q	•	•			•			•	•	•	•	•		Euro; Panasonic (2)	•	•	•	•	•	•		
Dex DM 3000	•	•			•			•						Euro	•	•						
Dex DM 3000 S	•	•			•			•						Panasonic	•	•	•	•	•	•		
Dex PM 3000	•	•			•			•			•			Euro	•	•						
Dex PM 3000 S	•	•			•			•			•			Euro	•	•	•	•	•	•		

• Standard
• Optional

Remark (1) Double pulse MIG/MAG for aluminum alloy is not available with Artsen II PM500/400/350 AS;
(2) Intermediate wire-feeder and push-pull torch are only applicable with Euro connector.
(3) QPT, Quick Power Technology. Welding speed of pulse MIG/MAG reaches 2 times of the standard pulse MIG/MAG. It lowers the sensitivity to shield gas for stainless steel welding.

Ehave CM 500H / 500 / 400 / 350 / 250

Heavy-duty CO₂/MAG/MMA Intelligent Welding Machine



- First-choice for harsh and heavy-duty working environment
- Extensively used in various industries with carbon steel welding: railway, automotive parts, shipbuilding, steel construction, shipping container manufacturing, furniture production, metal fabrication, etc.

Features:

- Stabilized welding arc and low spatter at all output range. It is suitable for both root welding at low current and filling welding of high deposition efficiency at high current.
- Strong penetration with concentrated welding arc. Heat input is lowered by 20% with smaller heat deformation for the same depth of penetration.
- Outstanding performance in gap-filling welding with low sensitivity to wire stick-out; suitable for various welding positions and unskilled welders.
- Dynamic droplet inspection and micro-control technology, which cuts output power immediately after the last metal transfer. The wire tip will be cleared to reduce time for ball-cleaning at situations of high quality welding. Better production efficiency can be ensured thanks to the higher success ratio of one-time ignition.
- Direct achievement of locking-up with a password, multiple welding parameters, even extended functions thru the hot keys on the front panel, without any necessity and extra cost of additional equipment.
- Default set of 10 welding parameters for both saving and activating. 99 sets are allowed at maximum for tailored design.
- Analog communication with robot as optional.



Specification

Manual	Ehave CM 500 H	Ehave CM 500	Ehave CM 400	Ehave CM 350	Ehave CM 250
Robotics	Ehave CM 500 H AR	Ehave CM 500 AR	Ehave CM 400 AR	Ehave CM 350 AR	Ehave CM 250 AR
Control Mode	Full Digital-Control				
Rated Input Voltage	AC 3PH 380V +/-25% (3PH 285V ~ 3PH 475V)				
Input Frequency	30 ~80 HZ				
Rated Input Power	24 KVA	22.3 KVA	16.8 KVA	13.5 KVA	8 KVA
Power Factor	0.93	0.93	0.94	0.94	0.94
Efficiency	86%				
Rated OCV	75 V	73.3 V	63.7 V	63.7 V	63.7 V
Rated Output Current	30 ~ 500 A	30 ~ 500 A	30 ~ 400 A	30 ~ 400 A	30 ~ 400 A
Rated Output Voltage	12 ~ 45 V	12 ~ 45 V	12 ~ 38 V	12 ~ 38 V	12 ~ 38 V
Duty Cycle	500A 100% @ 40°C	500A 60% @ 40°C 390A 100% @ 40°C	400A 60% @ 40°C 310A 100% @ 40°C	350A 60% @ 40°C 271A 100% @ 40°C	250A 100% @ 40°C 190A 100% @ 40°C
Applicable Material	Carbon Steel				
Welding Process	CO ₂ / MAG / FCAW / MMA				
Wire Diameter	φ 1.0 / 1.2 / 1.6 mm		φ 0.8 / 1.0 / 1.2 mm		
Welding Operation Mode	2T / 4T / Repeated 4T / Spot Welding				
Parameter Channel	10 (Standard)				
Inductance Scope (Soft / Strong Arc)	-9 ~ +9				
Communication with Robot Controller	Analog				
Reserved Communication Interface	CAN				
Cooling Mode	Intelligent Air Cool				
Wire-feeding Speed	1.4 ~ 24 m/min				
Electromagnetic Compatibility	IEC60974:10 EMS				
Insulation Grade	H				
Ingress Protection	IP 23S				
Protection Against Lightening	Class D (6000V/3000A)				
Working Temperature & Humidity	-39°C ~ +50°C ; Humidity ≤ 95%;				
Dimension (L / W / H)	620 x 300 × 480 mm				
Gross Weiaht	52 KG	52 KG	48 KG	48 KG	48 KG

Artsen CM 500C

Intelligent Welding Machine with Carrier-wave Communication for Industrial and Heavy-duty Conditions



- Professionally designed for shipbuilding, marine and offshore industry, and large-size steel construction.
- Born for long-distance Welding.
- Pioneer in carrier-wave technology for two-way communication.

Features:

- Statistics shows that 70% welding machines become defective on site because of the damaged control cable or its connectors. Thanks to the carrier-wave technology, cables are integrated. Reliability was greatly upgraded for higher production efficiency.
- Duty cycle of 100% for 500A output at 40°C.
- High wire-feeding speed of 24m/min to achieve high deposition efficiency.
- Outstanding protection design for the wire-feeder and PCBA to achieve stable performance in tough conditions like vibration, collision, moisture and salt damage.
- Long-distant welding up to 100 meters becomes practical and stable. Pioneer in the industry to apply carrier-wave technology for two-way communication between wire-feeder and power source.
- Allowing low amperage of 150A for upward vertical position of welding with flux-cored wire and with 50m connection cable.
- Allowing upward vertical position of welding in straight line for special-purposed flux-cored wire (E71T-1C). Comparing with weaving welding, heat input is largely reduced.
- Protecting the power source against short circuit from any of the peripheral cable sets. An error code will display in both the power source and the wire-feeder, and will disappear after short circuit is removed.
- Over-current protection for the wire-feeder against motor short circuit, stuck wire. Protection and recovery are both automatic.
- Automatic over-current / short circuit and open circuit protection for the electromagnetic valve.
- High-frequency inspection and control with full digital technology. Enabling a much more stabilized low current.
- Weight and dimension of external cables are greatly reduced, and brings convenience for mobility.



Artsen CM / PM II Series

Artsen CM 500 / 400 II (R)

Artsen PM 500 / 400 F / N / AS / AD II (R)

Full Digital-control Heavy-duty Pulse MIG/MAG/CO₂ Intelligent Welding Equipment



Product Features

- Independent operation panel and display in the wire-feeder, allowing convenient check and adjustment of welding parameters.
- Synchronous driving with 2 motors, flexible torch configuration, expansion capability with mid-way wire-feeder and push-pull torch. Practical for welding operation of long distance and in narrow space.
- Professional performance for materials, including carbon steel, stainless steel, aluminum alloy with DC, Pulsed DC and Double Pulsed DC process.
- Up to 50 channels with non-delay switch; up to 200 defect records bringing higher convenience to identify the on-site troubles.
- Abundant internal menu and specification opened to adjustment, meeting extreme welding demands.
- Diversified expert system and specialized program for aluminum welding ensuring the optimum welding result for different types of aluminum alloy.
- Full digital control at high speed, monitoring each phase of the metal transfer, achieving "One Pulse, One Droplet" precisely for a satisfactory welding result of extremely controlled spatter.
- Rich welding expert database; synergic adjustment allows automatic matching of key parameters and satisfactory welding result.
- Parameters of each welding steps open to adjustment, ensuring precise adjustment for different working conditions and achieve better welding quality.
- Upgradable process program to realize high efficiency welding of various special metal materials, such as high strength steel Q690, silicon bronze and aluminum bronze.

Artsen CM / PM II Series

Specification

Manual	Artsen PM 500 F / N / AS / AD II	Artsen CM 500 II	Artsen PM 400 F / N / AS / AD II	Artsen CM 400 II
Robotics	Artsen PM 500 F / N / AS / AD R II	Artsen CM 500 R II	Artsen PM 400 F / N / AS / AD R II	Artsen CM 400 R II
Control Mode	Full Digital-Control			
Rated Input Voltage	AC 3PH 380V +/-25% (3PH 285V ~ 3PH 475V)			
Input Frequency	30 ~80 HZ			
Rated Input Power	24 KVA	22.3 KVA	19.7 KVA/18KW	15 KVA/12.7KW
Power Factor	0.93			
Efficiency	87%			
Rated OCV	73.3 V			63.7 V
Rated Output Current	30 ~ 500 A	30 ~ 500 A	30 ~ 400 A	30 ~ 400 A
Rated Output Voltage	12 ~ 45 V (Precision at 0.1V)			
Duty Cycle	500A 60% @ 40°C 390A 100% @ 40°C	500A 60% @ 40°C 390A 100% @ 40°C	400A 100% @ 40°C	400A 100% @ 40°C
Applicable Material	F: Carbon Steel N: Carbon Steel / Stainless Steel AS/AD: Carbon Steel / Stainless Steel / Aluminum Alloy	Carbon Steel	F: Carbon Steel N: Carbon Steel / Stainless Steel AS/AD: Carbon Steel / Stainless Steel / Aluminum Alloy	Carbon Steel
Welding Process	VMIG / MAG / CO ₂ Pulse MIG / MAG Double Pulse MIG / MAG	MIG / MAG / CO ₂	MIG / MAG / CO ₂ Pulse MIG / MAG Double Pulse MIG / MAG	MIG / MAG / CO ₂
Wire Diameter	φ 0.8 / 1.0 / 1.2 / 1.6 mm		φ 0.8 / 1.0 / 1.2 mm	
Welding Operation Mode	2T / 4T / Special 4T / Spot Welding			
Parameter Channel	50 (Standard)			
Inductance Scope (Soft / Strong Arc)	-9 ~ +9			
Push-pull Torch Function (1)	Yes			
Communication with Robot Controller	Analog; DeviceNet; CAN Open; MEGMEET CAN; EtherNet/IP (2)			
Digital Meter on Wire-feeder	Yes			
Cooling Mode	Air Cool; Water Cool (Optional)			
Electromagnetic Compatibility	IEC60974:10 EMS			
Insulation Grade	H			
Ingress Protection	IP 23S			
Protection Against Lightning	Class D (6000V/3000A)			
Working Temperature & Humidity	-39°C ~ +50°C ; Humidity ≤ 95%;			
Dimension (L / W / H)	620 x 300 × 480 mm			
Gross Weight	52 KG			

Water Cooler (Optional)	
Rated Power	260W
Rated Voltage	AC 400V
Volume of Cooling Water	10L
Flow of Cooling Water	3.5L / min
Max Pump Head	30 m
Flow Alarm	Yes

(1) Please contact with MEGMEET to specify the model of the push-pull torch.
(2) EtherNet/IP is optional.